

**Administration Report  
Fiscal Year 2013/2014**

Poway Unified School District  
Improvement Area A  
Community Facilities District No. 14

June 24, 2013

**Prepared For:**

Poway Unified School District – Planning Department  
13626 Twin Peaks Road  
Poway, CA 92064  
T 858.679.0010

**Prepared By:**

Dolinka Group, LLC  
20 Pacifica, Suite 900  
Irvine, CA 92618  
T 949.250.8300  
F 949.250.8301

# Table of Contents

<b>Section</b>	<b>Page</b>
<b>Introduction</b> -----	<b>1</b>
<b>I. Fiscal Year 2012/2013 Levy Summary</b> -----	<b>3</b>
A. Special Tax Levy -----	3
B. Special Tax Delinquencies-----	3
<b>II. Financial Activity</b> -----	<b>4</b>
A. Sources of Funds-----	4
B. Uses of Funds-----	5
C. Fund and Account Balances-----	5
<b>III. Senate Bill 165 Compliance</b> -----	<b>6</b>
A. Authorized Facilities -----	6
B. Bond Proceeds -----	11
C. Construction/Acquisition Accounts -----	11
D. Special Tax Fund-----	12
<b>IV. Minimum Annual Special Tax Requirement</b> -----	<b>13</b>
<b>V. Development Summary</b> -----	<b>14</b>
<b>VI. Fiscal Year 2013/2014 Levy Summary</b> -----	<b>15</b>

## **Exhibits**

**Exhibit A:** Rate and Method of Apportionment

**Exhibit B:** Summary of Transactions for Funds and Accounts

**Exhibit C:** Annual Special Tax Roll for Fiscal Year 2013/2014

---

## **Introduction**

---

This Administration Report ("Report") provides an analysis of the financial and administrative obligations of Improvement Area ("IA") A of Community Facilities District ("CFD") No. 14 of the Poway Unified School District ("School District"), pursuant to the Rate and Method of Apportionment ("RMA") attached as Exhibit A, for the purpose of calculating the Annual Special Tax levy for Fiscal Year 2013/2014. In calculating the Annual Special Tax levy for Fiscal Year 2013/2014, the Report describes (i) the remaining financial obligations of IA A of CFD No. 14 for Fiscal Year 2012/2013, (ii) the financial obligations of IA A of CFD No. 14 for Fiscal Year 2013/2014, and (iii) the amount of new development which has occurred within the boundaries of IA A of CFD No. 14.

The Report is organized into the following sections:

### **Section I**

Section I provides a description of the Annual Special Tax levy for Fiscal Year 2012/2013 including any delinquent Annual Special Taxes.

### **Section II**

On June 22, 2006 the Improvement Area A 2006 Special Tax Bonds ("Bonds") were issued by IA A of CFD No. 14 in the amount of \$51,495,000. The Bonds were issued for the purpose of financing the Authorized Facilities of IA A of CFD No. 14, pursuant to the Resolution of Intention ("ROI") and are secured by and repaid from the annual levy of Special Taxes within IA A of CFD No. 14.

Section II examines the financial activity within the various funds and accounts established pursuant to the Improvement Area A Bond Indenture ("Indenture") dated May 1, 2006 by and between IA A of CFD No. 14 and Zions First National Bank, NA ("Fiscal Agent") from July 1, 2012 to April 30, 2013. A summary is provided which lists all disbursements, Annual Special Tax receipts, and interest earnings.

### **Section III**

Section III contains a description of (i) the initial allocation of Bond proceeds and (ii) the expenditure of Special Taxes and Bond proceeds to fund Authorized Facilities of IA A of CFD No. 14 through April 30, 2013, as directed by Senate Bill 165 ("SB 165").

### **Section IV**

Section IV calculates the Minimum Annual Special Tax Requirement based on the financial obligations of IA A of CFD No. 14 for Fiscal Year 2013/2014.

### **Section V**

Section V provides (i) a description of the Special Tax classifications and (ii) an update of the development which has occurred in IA A of CFD No. 14.

## **Section VI**

Section VI describes the methodology used to apportion the Minimum Annual Special Tax Requirement among the properties within IA A of CFD No. 14 and lists the Assigned Annual Special Tax rates for Fiscal Year 2013/2014.

## I. Fiscal Year 2012/2013 Levy Summary

### A. Special Tax Levy

The aggregate Annual Special Tax levy of IA A of CFD No. 14 in Fiscal Year 2012/2013 as well as a summary of the levy can be found in the table below.

#### Annual Special Tax Rates For Fiscal Year 2012/2013

Property Classification	Tax Class	Building Square Footage	Number of Units/Acres	Assigned Annual Special Tax Rate	Total Annual Special Taxes
Detached Unit	1	< 1,800	76 Units	\$2,299.68 per Unit	\$174,775.68
Detached Unit	2	1,800 – 2,000	153 Units	\$2,561.00 per Unit	\$391,833.00
Detached Unit	3	2,001 – 2,200	72 Units	\$2,887.66 per Unit	\$207,911.52
Detached Unit	4	2,201 – 2,400	58 Units	\$2,974.76 per Unit	\$172,536.08
Detached Unit	5	2,401 – 2,600	108 Units	\$2,996.54 per Unit	\$323,626.32
Detached Unit	6	2,601 – 2,800	62 Units	\$3,105.44 per Unit	\$192,537.28
Detached Unit	7	2,801 – 3,000	71 Units	\$3,301.42 per Unit	\$234,400.82
Detached Unit	8	3,001 – 3,200	90 Units	\$3,668.14 per Unit	\$330,132.60
Detached Unit	9	3,201 – 3,450	28 Units	\$4,067.98 per Unit	\$113,903.44
Detached Unit	10	> 3,450	44 Units	\$4,176.86 per Unit	\$183,781.84
Attached Unit	11	< 1,900	51 Units	\$2,060.14 per Unit	\$105,067.14
Attached Unit	12	1,900 – 2,100	10 Units	\$2,397.66 per Unit	\$23,976.60
Attached Unit	13	> 2,100	94 Units	\$2,656.82 per Unit	\$249,741.08
Affordable Unit	14	NA	0 Units	\$0.00 per Unit	\$0.00
<i>Developed Property</i>			<i>917 Units</i>	<i>NA</i>	<i>\$2,704,223.40</i>
<i>Undeveloped Property</i>			<i>39.26 Acres</i>	<i>\$13,178.49 per Acre</i>	<i>\$517,387.56</i>
<b>Total</b>					<b>\$3,221,610.96</b>

### B. Special Tax Delinquencies

Dolinka Group, LLC has received delinquency information for IA A of CFD No. 14 for Fiscal Year 2012/2013 from the County of San Diego ("County"). For Fiscal Year 2012/2013 (as of May 3, 2013), \$34,828.81 in Annual Special Taxes were delinquent yielding a delinquency rate of 1.08%.

---

## II. Financial Activity

---

This section summarizes the activity within the various funds and accounts created by the Indenture. For a more detailed description of the various funds and accounts, please see Section 3.01 of the Indenture. A detailed analysis of all transactions within these funds and accounts for this period is included as Exhibit B.

### A. Sources of Funds

Sources of funds for IA A of CFD No. 14 for the period of July 1, 2012 to April 30, 2013 are summarized in the table below.

#### Sources of Funds July 1, 2012 – April 30, 2013

Sources	Amount
Bond Proceeds	\$0.00
Special Tax Receipts	\$2,283,201.38
Investment Earnings <sup>[1]</sup>	\$522.64
Miscellaneous Sources	\$0.00
<b>Total</b>	<b>\$2,283,724.02</b>
[1] Data summarized in the table below.	

#### Investment Earnings July 1, 2012 – April 30, 2013

Funds and Accounts	Amount
Administrative Expense Fund	\$10.25
CalTrans Improvement Account	\$0.99
City Facilities Account	\$0.00
Interest Account	\$0.00
Letter of Credit Fund	\$0.00
LOC WL Home/Bay Laing 3C	\$9.82
Principal Account	\$0.00
Reserve Fund	\$403.06
Shea Cash Deposit 5A	\$13.05
Shea Cash Deposit 9C	\$0.00
Special Tax Fund	\$85.47
<b>Total</b>	<b>\$522.64</b>

**B. Uses of Funds**

Uses of funds for IA A of CFD No. 14 for the period of July 1, 2012 to April 30, 2013 are summarized in the table below.

**Uses of Funds  
July 1, 2012 – April 30, 2013**

<b>Funds and Accounts</b>	<b>Amount</b>
Interest Payments	\$2,605,185.00
Principal Payments	\$395,000.00
Acquisition/Construction Payments	\$0.00
Administrative Expenses	\$25,000.00
Miscellaneous Uses <sup>[1]</sup>	\$0.00
<b>Total</b>	<b>\$3,025,185.00</b>

**C. Fund and Account Balances**

The balances as of April 30, 2013 in the funds and accounts established pursuant to the Indenture are shown in the table below.

**Fund and Account Balances  
As of April 30, 2013**

<b>Funds and Accounts</b>	<b>Amount</b>
Administrative Expense Fund	\$150,769.80
CalTrans Improvement Account	\$12,194.18
City Facilities Account	\$1.73
Interest Account	\$240.30
Letter of Credit Fund	\$0.00
LOC WL Home/Bay Laing 3C	\$129,006.16
Principal Account	\$0.00
Reserve Fund	\$4,846,803.67
Shea Cash Deposit 5A	\$157,006.07
Shea Cash Deposit 9C	\$0.00
Special Tax Fund	\$1,019,049.26
<b>Total</b>	<b>\$6,315,071.17</b>

---

### **III. Senate Bill 165 Compliance**

---

The Board of Education ("Board") of the School District, pursuant to the provisions of the Local Agency Special Tax and Bond Accountability Act ("Accountability Act"), has directed the filing of the Special Tax and Bond Accountability Report for IA A of CFD No. 14. According to Senate Bill ("SB") 165, any local special tax and/or bond measure subject to voter approval on or after January 1, 2001, must follow the requirements of the Accountability Act. All capitalized terms herein are used as defined in the RMA of IA A of CFD No. 14.

#### **A. Authorized Facilities**

Pursuant to the Mello Roos Community Facilities Act of 1982, as Amended ("Act"), IA A of CFD No. 14 can only be used to fund the "Authorized Facilities" as outlined at the time of formation. The following is an excerpt taken from the ROI to establish IA A of CFD No. 14 which describes the Authorized Facilities.

#### **Description of School Facilities**

"School Facilities" means the acquisition, planning, construction and/or financing of those school facilities, including classrooms, multi-purpose, administration and auxiliary space at each school, central support and administrative facilities, interim housing, transportation and special education facilities, together with furniture, equipment and technology, needed by District in order to serve directly or indirectly the student population to be generated as a result of the development of the property within CFD No. 14, together with all land or interests in land required for the construction of such school facilities and land or interests in land required to be provided by the District as mitigation of environmental impacts associated with the development of such school facilities as well as all that portion of the related incidental expenses and the costs to the District related to the negotiation, execution and implementation of the supplement to the Subarea I Black Mountain Ranch Phase II School Impact Mitigation Agreement dated as of July 1, 1998 (the "Mitigation Agreement") between the District and Black Mountain Ranch Limited Partnership.

The School Facilities shall also include the attributable costs of engineering, design, planning, materials testing, coordination, construction staking and construction, together with the expenses related to the issuance and sale of an "debt" as defined in Section 53317(d) of the Act, including but not limited to, underwriters' discount, appraisals, market studies, reserve fund, capitalized interest, bond counsel, special tax consultant, bond and official statement printing, administrative expenses of the District, CFD No. 14 and bond trustees or fiscal agent related to CFD No. 14 and any such debt and all other incidental expenses.

The School Facilities shall be constructed, whether or not acquired in their completed states, pursuant to plans and specifications approved by the District.



The School Facilities listed are representative of the types of improvements authorized to be financed by CFD No. 14. Detailed scope and limits of specific projects will be determined as appropriate, consistent with the standards of the District. Addition, deletion, or modification of descriptions of School Facilities may be made consistent with the requirement of the Board of Education of the District, the CFD and the Act.

### **Description of City Improvements**

"City Improvements" means the acquisition, planning, construction and/or financing of those improvements to be owned by the City of San Diego (the "City"), including the following:

#### **A. Transportation Improvements**

1. Rancho Penasquitos Intersections
2. Camino Del Sur (San Dieguito Road to Bong Crosby Drive – 2 Lanes)
  - a. Backbone Potable Water Line in Roadway
  - b. Backbone Sewer Line in Roadway
3. Camino Del Sur Widening (San Dieguito Road to Bing Crosby Drive – add 2 Lanes)
4. Camino Del Sur North Wildlife Crossing (2 Lanes)
5. Camino Del Sur North Wildlife Crossing Widening (add 2 Lanes)
6. Camino Del Sur Widening (San Dieguito Road South to Carmel Valley Road – add 2 Lanes)
7. Camino Del Sur South Wildlife Crossing Widening (add 2 Lanes)
8. Camino Del Sur Widening (Carmel Valley Road south to SR-56)
9. Camino Del Sur at SR-56 (Construct diamond interchange)
10. SR-56 Bike Interchanges
11. Carmel Valley Road (Del Mar Heights Road to Via Abertura, widen to 4 lanes)
12. Carmel Valley Road (Widen to 4 Lanes: Camino Del Sur to Black Mountain Road)
13. Carmel Valley Road (Black Mountain Road east to Camino Crisalida-4 Lanes)
14. Carmel Valley Road East Wildlife Crossing (between Black Mountain Road and Camino Crisalida-4 Lanes)
15. El Camino Real Widening (Half Mile Drive north to San Dieguito Road-add 2 Lanes)
16. El Camino Real Widening (San Dieguito Road north to Via de la Valle-add 2 Lanes)
17. El Camino Real (Studies to support EIS/EIR)
18. Via de la Calle Widening (West El Camino Real to San Andreas add 2 Lanes)
19. Via de la Valle (Retaining Walls for Bike Path)
20. Camino Del Sur (Bing Crosby Drive east to City Limits – 4 Lanes)
21. Camino Del Norte at Bernardo Center Drive Intersection Improvements
22. Rancho Bernardo Road Widening (I-15 east to Bernardo Center Drive-add 2 Lanes)
23. West Bernardo Drive Spots Improvements (1-15 South to Agumiel Road)

24. West Bernardo Drive at Bernardo Center Drive Intersection Improvements
  25. Paseo Del Sur (Camino del sur east to Camino San Bernardo – 4 Lanes)
    - a. Backbone Potable Water Line in Roadway
    - b. Backbone Sewer Line in Roadway
  26. Camino San Bernardo (Paseo del Sur east City Limit)
  27. San Dieguito Road Spot Improvements (El Camino Real east to City Limit/Subarea I)
  28. Black Mountain Road Widening (Twin Trails Road south to Mercy Road)
  29. Subarea I Transit Program
  30. El Camino Real (Extension of right turn lane between Valley Center and Carmel Valley Road)
- B. Park Improvements
1. Community Park
  2. Community Recreation Building
  3. Community Swimming Pool
  4. North Neighborhood Park
  5. Trail-North Loop
- C. Fire Station Improvements
1. North Fire Station
- D. Library Improvements
1. Branch Library
- E. Water/Sewer Improvements
1. Carmel Valley Trunk Sewer
  2. Backbone Potable Water Distribution System
  3. Offsite – Recycled Water Line – from Santaluz to Golf Course
  4. Backbone Recycled Water Distribution System
  5. Backbone Sewer Collection System
  6. Sewer Pump Station No. 90
- F. City and CalTrans Improvements
1. Carmel Valley Road at I-5 Southbound Ramp
  2. Camino Del Norte at I-15 Ramp Improvements
  3. West Bernardo Drive at I-15 Ramp Improvements
  4. Bernardo Center Drive at I-15 Ramp Improvements
  5. SR-56 Widening (I-5 to I-15-add 2 lanes/HOV lanes and Auxiliary Lane)
  6. Interstate 15 Enhancements (Lake Hodges Bridge south to SR-56)
  7. SR-56 at I-15 Interchange Improvements
  8. SR-56 at I-5 Interchange Improvements
  9. SR-56 Auxiliary Lanes (Between west bound off-ramp and west bound on-ramp at Carmel Creek Road)

- G. Non – FBA Streets and Arterials to Support School Facilities
1. Babcock Street – "AL" Street – Camino Del Sur to Paseo Del Sur
  2. Tanner Ridge – Camino Del Sur to Paseo Del Sur
  3. "AO" Street – Camino Del Sur to Paseo Del Sur
  4. Nicole Ridge Road – Camino Del Sur to Paeso Del Sur
  5. "AS" Street – Lone Quail Road to West Side of "AP" Street
  6. "AP" Street – "AY" Street to "AS" Street
  7. "AY" Street – Eastern Boundary to Nicole Ridge Road
  8. Haaland Glen – Paseo Del Sur to Paseo Montero ("R" Street)
  9. Paeso Montero – "R" Street – South side of Haaland Glen to Paseo Del Sur

The City Improvements shall also include the attributable costs of right of way acquisition, grading and site preparation, slope and erosion control, sanitary sewers, storm drainage, water distribution facilities, traffic singles, street lighting, street paving, curb gutter, sidewalk, median, landscaping, dry utilities, engineering, design, planning, material testing, coordination, construction staking and construction, construction management and supervision together with the expenses related to the issuance and sale of any "debt" as defined in Section 53317(d) of the Act, including but not limited to, underwrites' discount, appraisals, market studies, reserve fund, capitalized interest, bond counsel, special tax consultant, bond and official statement printing, administrative expenses of the District, CFD No. 14 and bond trustee of Fiscal agent related to any Improvements Area in CFD No. 14 and any such debt and all other incidental expenses.

The City Improvements shall be constructed, whether or not acquired in their completed states, pursuant to plans and specifications approved by the City.

The City Improvements listed in this Exhibit B are representative of the types of improvements that are to be owned, operated and maintained by the City and to be financed by CFD No. 14. Detailed scope and limits of specific projects will be determined as appropriate, consistent with the standards of the City. Addition, deletion, or modification of descriptions of City Improvements may be made consistent with the requirements of the City subject to the approval by the Board of Education of the District, CFD No. 14 and the Act.

### **Description of CalTrans Improvements**

"CalTrans Improvements" means the acquisition, planning, construction and/or financing of those improvements to be owned by the California Department of Transportation ("CalTrans"), including the following:

1. Interstate 15 Enhancements (Lake Hodges Bridge south to SR-56)
2. SR-56 at I-15 Interchange Improvements

The CalTrans Improvements shall also include the attributable costs of right of way acquisition, grading and site preparation, slope and erosion control, sanitary sewers, storm drainage, water distribution facilities, traffic signals, street lighting, street paving, curb, gutter, sidewalk, median, landscaping, dry utilities, engineering, design, planning, materials testing, coordination, construction staking and construction, construction management and supervision together with the expenses related to the issuance and sale of any "debt" as defined in Section 53317(d) of the Act, including but not limited to, underwriters' discount, appraisals, market studies, reserve fund, capitalized interest, bond counsel, special tax consultant, bond and official statement printing, administrative expenses of the District, CFD No. 14 and bond trustee of fiscal agent related to any Improvement Area in CFD No. 14 and any such debt and all other incidental expenses.

The CalTrans Improvements shall be constructed, whether or not acquired in their completed status, pursuant to plans and specifications approved by CalTrans.

The CalTrans Improvements listed in this Exhibit B are representative of the types of improvements that are to be owned, operated and maintained by CalTrans and to be financed by CFD No. 14. Detailed scope and limits of specific projects will be determined as appropriate, consistent with the standards of CalTans. Addition, deletion, or modification of descriptions of CalTrans Improvements may be made consistent with the requirements of the CalTrans subject to the approval by the Board of Education of the District, CFD No. 14 and the Act.

**B. Bond Proceeds**

In accordance with the Indenture by and between the School District and the Fiscal Agent, the proceeds of the Bonds were deposited into the funds and accounts shown in the table below.

**Initial Deposit of Bond Proceeds**

<b>Funds and Accounts</b>	<b>Initial Deposit</b>
Special Tax Fund	\$0.00
Bond Service Fund	\$0.00
Interest Account of the Bond Service Fund	\$0.00
Capitalized Interest Subaccount of the Interest Account <sup>[1]</sup>	\$3,159,763.75
Principal Account of the Bond Service Fund	\$0.00
Costs of Issuance Fund <sup>[2]</sup>	\$1,074,178.75
Improvement Fund	\$0.00
City Improvement Account of the Improvement Fund	\$33,242,960.77
CalTrans Improvement Account of the Improvement Fund	\$9,369,000.00
Reserve Fund	\$4,599,096.73
Rebate Fund	\$0.00
Redemption Fund	\$0.00
Administrative Expense Fund	\$50,000.00
Letter of Credit Fund	\$0.00
<b>Total Bond Proceeds</b>	<b>\$51,495,000.00</b>
[1] Bond proceeds were deposited into Capitalized Interest Subaccount to cover Interest through September 2007.	
[2] This amount includes the Underwriter's Discount of \$566,445.00 and the Original Issue Discount of \$103,733.75. The actual amount deposited in the Costs of Issuance Account was \$404,000.00.	

**C. Construction/Acquisition Accounts**

The table below shows the accruals and expenditures in the construction/acquisition accounts of IA A of CFD No. 14 from the Bond inception date through April 30, 2013.

**City Facilities Account**

<b>Balance as of June 22, 2006</b>		<b>\$33,242,960.77</b>
<b>Previously Accrued</b>	<b>\$1,264,294.17</b>	
<b>Previously Expended</b>	<b>(\$34,507,253.21)</b>	
<b>Balance as of April 30, 2012</b>		<b>\$1.73</b>
<b>Accruals</b>		<b>\$0.00</b>
<b>Expenditures</b>		<b>\$0.00</b>
<b>Balance as of April 30, 2013</b>		<b>\$1.73</b>

**CalTrans Improvement Account**

<b>Balance as of June 22, 2006</b>		<b>\$9,369,000.00</b>
<b>Previously Accrued</b>	<b>\$489,131.77</b>	
<b>Previously Expended</b>	<b>(\$9,845,938.78)</b>	
<b>Balance as of April 30, 2012</b>		<b>\$12,192.99</b>
<b>Accruals</b>		<b>\$1.19</b>
Interest Earnings	\$1.19	
<b>Expenditures</b>		<b>\$0.00</b>
<b>Balance as of April 30, 2013</b>		<b>\$12,194.18</b>

**D. Special Tax Fund**

Each Fiscal Year, IA A of CFD No. 14 will levy, collect, and expend Annual Special Taxes in an amount necessary to pay interest and principal to bondholders, cover Administrative Expenses, and fund school facilities necessary to serve students generated from residential units constructed within the boundaries of IA A of CFD No. 14. The table below presents a detailed listing of the Annual Special Taxes collected and expended by IA A of CFD No. 14 from June 22, 2006 through April 30, 2013.

**Special Tax Fund**

<b>Balance as of June 22, 2006</b>		<b>\$0.00</b>
<b>Previously Accrued</b>	<b>\$13,752,063.69</b>	
<b>Previously Expended</b>	<b>(\$13,123,452.28)</b>	
<b>Balance as of April 30, 2012</b>		<b>\$628,611.41</b>
<b>Accruals</b>		<b>\$3,471,604.50</b>
Special Tax Receipts	\$3,471,499.07	
Investment Earnings	\$105.43	
<b>Expenditures</b>		<b>(\$3,081,166.65)</b>
Transfer to the Administrative Expense Fund	(\$57,434.28)	
Transfer to Interest Account	(\$2,605,425.30)	
Transfer to Principal Account	(\$395,000.00)	
Transfer to Reserve Fund	(\$23,307.07)	
<b>Balance as of April 30, 2013</b>		<b>\$1,019,049.26</b>

#### IV. Minimum Annual Special Tax Requirement

For Fiscal Year 2013/2014, the Minimum Annual Special Tax Requirement for IA A of CFD No. 14, as calculated pursuant to the RMA, can be found in the table below.

##### Minimum Annual Special Tax Requirement For Fiscal Year 2013/2014

<b>FY 2012/2013 Current and Projected Funds</b>		<b>\$1,939,905.01</b>
Balance of the Special Tax Fund (as of April 30, 2013)	\$1,019,049.26	
Balance of the Interest Account (as of April 30, 2013)	\$240.30	
Excess Reserve Fund Balance (as of April 30, 2013)	\$41.17	
Projected Special Tax Receipts	\$920,574.28	
<b>FY 2012/2013 Remaining Obligations</b>		<b>\$1,773,247.50</b>
Interest Payment Due September 1, 2013	\$1,298,247.50	
Principal Payment Due September 1, 2013	\$475,000.00	
<b>FY 2012/2013 Surplus/(Draw on Reserve)</b>		<b>\$166,657.51</b>
<b>FY 2013/2014 Obligations</b>		<b>\$3,378,241.89</b>
Interest Payment Due March 1, 2014	\$1,287,560.00	
Interest Payment Due September 1, 2014	\$1,287,560.00	
Principal Payment Due September 1, 2014	\$560,000.00	
Administrative Expense Budget for Fiscal Year 2013/2014	\$58,582.97	
Anticipated Special Tax Delinquencies (5.00%) <sup>[1]</sup>	\$167,714.11	
Surplus	\$16,824.81	
<b>Minimum Annual Special Tax Requirement</b>		<b>\$3,211,584.38</b>
[1] An additional delinquency contingency has been added due to insufficient taxing history.		

## V. Development Summary

Each Fiscal Year, the School District calculates the Annual Special Taxes to be levied against Taxable Property within IA A of CFD No. 14. Taxable Property is classified based on the issuance of a Building Permit. Specifically, Developed Property means, for any Fiscal Year, all Assessor's Parcels in IA A of CFD No. 14 for which a Building Permit has been issued as of May 1 of the previous Fiscal Year, provided that the Assessor's Parcel was created prior to January 1 of the prior Fiscal Year and that each such Assessor's Parcel is associated with a Lot. The table below summarizes the Special Tax classification within IA A of CFD No. 14 for the previous Fiscal Year and Fiscal Year 2013/2014.

**Special Tax Classification**

<b>Property Classification</b>	<b>Tax Class</b>	<b>Building Square Footage</b>	<b>Previous Fiscal Year</b>	<b>Fiscal Year 2013/2014</b>
Detached Unit	1	< 1,800	76 Units	76 Units
Detached Unit	2	1,800 – 2,000	153 Units	153 Units
Detached Unit	3	2,001 – 2,200	72 Units	72 Units
Detached Unit	4	2,201 – 2,400	58 Units	58 Units
Detached Unit	5	2,401 – 2,600	108 Units	109 Units
Detached Unit	6	2,601 – 2,800	62 Units	72 Units
Detached Unit	7	2,801 – 3,000	71 Units	97 Units
Detached Unit	8	3,001 – 3,200	90 Units	106 Units
Detached Unit	9	3,201 – 3,450	28 Units	45 Units
Detached Unit	10	> 3,450	44 Units	74 Units
Attached Unit	11	< 1,900	51 Units	65 Units
Attached Unit	12	1,900 – 2,100	10 Units	10 Units
Attached Unit	13	> 2,100	94 Units	110 Units
Affordable Unit	14	NA	0 Units	0 Units
<i>Developed Property</i>			<i>917 Units</i>	<i>1,047 Units</i>
<i>Undeveloped Property</i>			<i>39.26 Acres</i>	<i>20.03 Acres</i>
<b>Total</b>			<b>917 Units</b>	<b>1,047 Units</b>



## VI. Fiscal Year 2013/2014 Levy Summary

The Special Tax rates of IA A of CFD No. 14 needed to meet the Minimum Annual Special Tax Requirement for Fiscal Year 2013/2014 are shown in the table below. The Special Tax roll, which lists the actual Special Tax levied against each Assessor's Parcel, is included as Exhibit C. For a more detailed explanation of the methodology used to apportion the Minimum Annual Special Tax Requirement among Developed Property and Undeveloped Property, please see the RMA.

### Annual Special Tax Rates For Fiscal Year 2013/2014

Property Classification	Tax Class	Building Square Footage	Number of Units/Acres	Assigned Annual Special Tax Rate	Total Annual Special Taxes
Detached Unit	1	< 1,800	76 Units	\$2,345.66 per Unit	\$178,270.16
Detached Unit	2	1,800 – 2,000	153 Units	\$2,612.22 per Unit	\$399,669.66
Detached Unit	3	2,001 – 2,200	72 Units	\$2,945.40 per Unit	\$212,068.80
Detached Unit	4	2,201 – 2,400	58 Units	\$3,034.26 per Unit	\$175,987.08
Detached Unit	5	2,401 – 2,600	109 Units	\$3,056.48 per Unit	\$333,156.32
Detached Unit	6	2,601 – 2,800	72 Units	\$3,167.54 per Unit	\$228,062.88
Detached Unit	7	2,801 – 3,000	97 Units	\$3,367.44 per Unit	\$326,641.68
Detached Unit	8	3,001 – 3,200	106 Units	\$3,741.50 per Unit	\$396,599.00
Detached Unit	9	3,201 – 3,450	45 Units	\$4,149.34 per Unit	\$186,720.30
Detached Unit	10	> 3,450	74 Units	\$4,260.40 per Unit	\$315,269.60
Attached Unit	11	< 1,900	65 Units	\$2,101.34 per Unit	\$136,587.10
Attached Unit	12	1,900 – 2,100	10 Units	\$2,445.62 per Unit	\$24,456.20
Attached Unit	13	> 2,100	110 Units	\$2,709.96 per Unit	\$298,095.60
Affordable Unit	14	NA	0 Units	\$0.00 per Unit	\$0.00
<i>Developed Property</i>			<i>1,047 Units</i>	<i>NA</i>	<i>\$3,211,584.38</i>
<i>Undeveloped Property</i>			<i>20.03 Acres</i>	<i>\$0.00 per Acre</i>	<i>\$0.00</i>
<b>Total</b>					<b>\$3,211,584.38</b>

S:\Clients\Poway Unified SD\SADMCFDs\CFD No. 14 Improvement Area A\FY1314\Reports\Annual\_SB165 Report\AdmRpt\_13600-1316\_Fn.docx

**Exhibit A**

**Rate and Method of Apportionment**

**RATE AND METHOD OF APPORTIONMENT FOR  
IMPROVEMENT AREA NO. A OF  
COMMUNITY FACILITIES DISTRICT NO. 14  
OF POWAY UNIFIED SCHOOL DISTRICT**

The following sets forth the Rate and Method of Apportionment for the levy and collection of Special Taxes ("Rate and Method of Apportionment") of Improvement Area No. A ("IA No. A") of Community Facilities District No. 14 ("CFD No. 14") of the Poway Unified School District ("School District"). An Annual Special Tax shall be levied on and collected on Taxable Property (defined below) located within the boundaries of IA No. A of CFD No. 14 each Fiscal Year in an amount determined through the application of the Rate and Method of Apportionment described below. All of the real property in IA No. A of CFD No. 14, unless exempted by law or by the provisions hereof, shall be taxed for the purposes, to the extent, and in the manner herein provided.

**SECTION A  
DEFINITIONS**

For purposes of this Rate and Method of Apportionment the terms hereinafter set forth have the following meanings:

**"Acreage"** means the number of acres of land area of an Assessor's Parcel as shown on an Assessor's Parcel Map, or if the land area is not shown on an Assessor's Parcel Map, the Board may rely on the land area shown on the applicable final map, parcel map, condominium plan, or other recorded County parcel map.

**"Act"** means the Mello-Roos Communities Facilities Act of 1982, as amended, being Chapter 2.5, Division 2 of Title 5 of the Government Code of the State of California.

**"Administrative Expenses"** means any ordinary and necessary expense incurred by the School District on behalf of IA No. A of CFD No. 14 related to the determination of the amount of the levy of Special Taxes, the collection of Special Taxes, including the reasonable expenses of collecting delinquencies, the administration of Bonds, the proportionate payment of salaries and benefits of any School District employee whose duties are directly related to the administration of IA No. A of CFD No. 14, and reasonable costs otherwise incurred in order to carry out the authorized purposes of IA No. A of CFD No. 14.

**"Affordable Unit"** means an Attached Unit that is subject to affordable housing restrictions under any applicable law.

**"Annual Special Tax"** means the Special Tax actually levied in any Fiscal Year on any Assessor's Parcel.

**"Assessor's Parcel"** means a lot or parcel of land designated on an Assessor's Parcel Map with an assigned Assessor's Parcel Number within the boundaries of IA No. A of CFD No. 14.

**"Assessor's Parcel Map"** means an official map of the Assessor of the County designating parcels by Assessor's Parcel Number.

**"Assessor's Parcel Number"** means that number assigned to an Assessor's Parcel by the County for purposes of identification.

**"Assigned Annual Special Tax"** means the Special Tax of that name described in Section D.

**"Attached Unit"** means a Unit that is located or shall be located within a building in which each of the individual Units has or shall have at least one common wall with another Unit.

**"Backup Annual Special Tax"** means the Special Tax of that name described in Section E.

**"Board"** means the Board of Education of Poway Unified School District, or its designee, in certain cases acting as the Legislative Body of IA No. A of CFD No. 14.

**"Bond Index"** means the national Bond Buyer Revenue Index, commonly referenced as the 25-Bond Revenue Index. In the event the Bond Index ceases to be published, the index used shall be based on a comparable index for revenue bonds maturing in 30 year with an average rating equivalent to Moody's A1 and/or S&P's A+, as reasonably determined by the Board.

**"Bond Yield"** means the yield of the last series of Bonds issued, for purposes of this calculation the yield of the Bonds shall be the yield calculated at the time such Bonds are issued, pursuant to Section 148 of the Internal Revenue Code of 1986, as amended for the purpose of the Non-Arbitrage Certificate or other similar bond issuance document.

**"Bonds"** means any obligation to repay a sum of money, including obligations in the form of bonds, notes, certificates of participation, long-term leases, loans from government agencies, or loans from banks, other financial institutions, private businesses, or individuals, or long-term contracts, or any refunding thereof, to which the Special Taxes have been pledged for repayment.

**"Building Permit"** means a permit for the construction of one or more Units issued by the City, or another public agency in the event the City no longer issues said permits for the construction of Units within IA No. A of CFD No. 14. For purposes of this definition, "Building Permit" shall not include permits for construction or installation of structures, parking structures, retaining walls, utility improvements, or other such improvements not intended for human habitation or commercial/industrial use.

**"Building Square Footage"** or **"BSF"** means the square footage of assessable internal living space of a Unit, exclusive of any carports, walkways, garages, overhangs, patios, enclosed patios, detached accessory structure, other structures not used as living space, or any other square footage excluded under Government Code Section 65995 as determined by reference to the Building Permit for such Unit.

**"City"** means the City of San Diego.

**"Commercial/Industrial Property"** means all Assessor's Parcels of Developed Property other than Residential Property.

**"County"** means the County of San Diego.

**"Developed Property"** means all Assessor's Parcels of Taxable Property for which Building Permits were issued on or before May 1 of the prior Fiscal Year, provided that such Assessor's Parcels were created on or before January 1 of the prior Fiscal Year and that each such Assessor's Parcel is associated with a Lot, as determined reasonably by the Board.

**"Detached Unit"** means a Unit which is not an Attached Unit.

**"Exempt Property"** means all Assessor's Parcels designated as being exempt from Special Taxes in Section K each Fiscal Year as determined May 1<sup>st</sup> of the previous Fiscal Year.

**"Final Subdivision Map"** means a final tract map, parcel map, lot line adjustment, or functionally equivalent map or instrument that creates individual Lots, recorded in the County Office of the Recorder.

**"Fiscal Year"** means the period commencing on July 1 of any year and ending the following June 30.

**"Gross Floor Area" or "GFA"** means, for an Assessor's Parcel of Commercial/Industrial Property, the covered and enclosed space determined to be within the perimeter of a commercial or industrial structure, not including any storage areas incidental to the principal use of the development, garage, parking structure, unenclosed walkway, utility, or disposal area. The determination of Gross Floor Area shall be made by the Board in accordance with the standard practice of the building department of the City.

**"Homeowner"** means any owner of a completed Unit constructed and sold within IA No. A of CFD No. 14.

**"Lot"** means an individual legal lot created by a Final Subdivision Map for which a Building Permit for residential construction has been or could be issued. Notwithstanding the foregoing, in the case of an individual legal lot created by such a Final Subdivision Map upon which condominium units are entitled to be developed but for which a condominium plan has not been recorded, the number of Lots allocable to such legal lot for purposes of calculating the Backup Special Tax applicable to such Final Subdivision Map shall equal the number of condominium units which are permitted to be constructed on such legal lot as shown on such Final Subdivision Map.

**"Maximum Special Tax"** means the maximum Special Tax, determined in accordance with Section C, that can be levied by IA No. A of CFD No. 14 in any Fiscal Year on any Assessor's Parcel.

**"Minimum Annual Special Tax Requirement"** means the amount required in any Fiscal Year to pay: (i) the debt service or the periodic costs on all outstanding Bonds, (ii) Administrative Expenses of IA No. A of CFD No. 14, (iii) the costs associated with the release of funds from an escrow account(s) established in association with the Bonds, and (iv) any amount required to establish or replenish any reserve funds (or accounts thereof) established in association with the Bonds, less (v) any amount(s) available to pay debt service or other periodic costs on the Bonds pursuant to any applicable bond indenture, fiscal agent agreement, trust agreement, or equivalent agreement or document. In arriving at the Minimum Annual Special Tax requirement the Board shall take into account the reasonably anticipated delinquent Special Taxes based on the delinquency rate for Special Taxes levied in the previous Fiscal Year.

**"Minimum Taxable Acreage"** means the applicable Acreage listed in Table 3 set forth in Section K.

**"Net Taxable Acreage"** means the total Acreage of all Taxable Property expected to exist in IA No. A of CFD No. 14 after all Final Subdivision Maps are recorded.

**"Partial Prepayment Amount"** means the amount required to prepay a portion of the Annual Special Tax obligation for an Assessor's Parcel as described in Section H.

**"Prepayment Administrative Fees"** means any fees or expenses of the School District or IA No. A of CFD No. 14 associated with the prepayment of the Special Tax obligation of an Assessor's Parcel. Prepayment Administrative Fees shall include among other things the cost of computing the Prepayment Amount, redeeming Bonds, and recording any notices to evidence the prepayment and redemption of Bonds.

**"Prepayment Amount"** means the amount required to prepay the Annual Special Tax obligation in full for an Assessor's Parcel as described in Section G.

**"Present Value of Taxes"** means for any Assessor's Parcel the present value of (i) the unpaid portion, if any, of the Special Tax applicable to such Assessor's Parcel in the current Fiscal Year and (ii) the Annual Special Taxes expected to be levied on such Assessor's Parcel in each remaining Fiscal Year, as determined by the Board, until the termination date specified in Section J. The discount rate used for this calculation shall be equal to the (i) Bond Yield after Bond issuance or (ii) most recently published Bond Index prior to Bond issuance.

**"Proportionately"** means that the ratio of the actual Annual Special Tax levy to the applicable Assigned Annual Special Tax or Maximum Annual Special Tax is equal for all applicable Assessor's Parcels.

**"Reserve Fund Credit"** means an amount equal to the reduction in the applicable reserve fund requirement(s) resulting from the redemption of Bonds with the Prepayment Amount. In the event that a surety bond or other credit instrument satisfies the reserve requirement or the reserve requirement is under funded at the time of the prepayment no Reserve Fund Credit shall be given.

**"Residential Property"** means all Assessor's Parcels of Developed Property which a Building Permit was issued for the construction of one or more Units.

**"Senior Citizen Unit"** means a Unit designated as senior citizen housing, part of a residential care facility for the elderly, or part of a multilevel care facility for the elderly as referred to in California Government Code Section 65995.1. For the purpose hereof it shall be sufficient to designate a Unit as a Senior Citizen Unit if Senior Citizen Restrictions have been affected with respect to such Unit.

**"Senior Citizen Restriction"** means (i) a restriction limiting the use of Units to senior citizen housing under a specific plan, a final map or other governmental entitlements, or a declaration of covenants, conditions and restrictions or any similar recorded instrument or (ii) licensing from appropriate agencies received for residential care facilities for the elderly or multilevel care facilities as those terms are defined in Health and Safety Code Section 1569.23 and Government Code Section 15432(d)(8), respectively.

**"Special Tax"** means any of the special taxes authorized to be levied by IA No. A of CFD No. 14 pursuant to the Act.

**"Taxable Property"** means all Assessor's Parcels which are not Exempt Property.

**"Undeveloped Property"** means all Assessor's Parcels of Taxable Property which are not Developed Property.

**"Unit"** means each separate residential dwelling unit which comprises an independent facility capable of conveyance separate from adjacent residential dwelling units. Each Unit shall be classified as an Attached Unit or a Detached Unit.

## **SECTION B CLASSIFICATION OF ASSESSOR'S PARCELS**

For each Fiscal Year, beginning with Fiscal Year 2006-07, each Assessor's Parcel within IA No. A of CFD No. 14 shall be classified as Taxable Property or Exempt Property. Furthermore, each Assessor's Parcel of Taxable Property shall be classified as Developed Property or Undeveloped Property and Developed Property shall be further classified as Residential Property or Commercial/Industrial Property. Residential Property shall be classified by unit type (e.g. Detached Unit, Attached Unit, Senior Citizen Unit, or Affordable Unit) and Detached Units and Attached Units shall be classified based on the Building Square Footage of the Unit. The classification of Exempt Property shall take into consideration the Minimum Taxable Acreage as determined pursuant to Section K.

## **SECTION C MAXIMUM SPECIAL TAXES**

### **1. Developed Property**

The Maximum Special Tax for each Assessor's Parcel classified as Developed Property for any Fiscal Year shall be the amount determined by the greater of (i) the application of the Assigned Annual Special Tax or (ii) the application of the Backup Annual Special Tax for a given Final Subdivision Map.

**2. Undeveloped Property**

The Maximum Special Tax for each Assessor's Parcel classified as Undeveloped Property for any Fiscal Year shall be the amount determined by the application of the Assigned Annual Special Tax.

**SECTION D  
ASSIGNED ANNUAL SPECIAL TAXES**

**1. Developed Property**

The Assigned Annual Special Tax in Fiscal Year 2006-07 for each Assessor's Parcel of Developed Property shall be the amount determined by reference to Table 2 subject to increases as described below.

**TABLE 2  
ASSIGNED ANNUAL SPECIAL TAX FOR  
DEVELOPED PROPERTY  
FISCAL YEAR 2006-07**

<b>Property Type</b>	<b>Unit Type</b>	<b>Building Square Footage</b>	<b>Assigned Annual Special Tax</b>
Residential Property	Detached Unit	< 1,800	\$2,042.05 per Unit
Residential Property	Detached Unit	1,800 – 2,000	\$2,274.10 per Unit
Residential Property	Detached Unit	2,001 – 2,200	\$2,564.16 per Unit
Residential Property	Detached Unit	2,201 – 2,400	\$2,641.51 per Unit
Residential Property	Detached Unit	2,401 – 2,600	\$2,660.85 per Unit
Residential Property	Detached Unit	2,601 – 2,800	\$2,757.54 per Unit
Residential Property	Detached Unit	2,801 – 3,000	\$2,931.58 per Unit
Residential Property	Detached Unit	3,001 – 3,200	\$3,257.22 per Unit
Residential Property	Detached Unit	3,201 – 3,450	\$3,612.26 per Unit
Residential Property	Detached Unit	> 3,450	\$3,708.94 per Unit
Residential Property	Attached Unit	< 1,900	\$1,829.34 per Unit
Residential Property	Attached Unit	1,900 – 2,100	\$2,129.07 per Unit
Residential Property	Attached Unit	> 2,100	\$2,359.19 per Unit
Residential Property	Affordable Unit	NA	\$0.00 per Unit
Residential Property	Senior Citizen Unit	NA	\$0.00 per Unit
Commercial/Industrial Property	NA	NA	\$0.00 per GFA



Each July 1, commencing July 1, 2007, the Assigned Annual Special Tax for each Assessor's Parcel of Developed Property shall be increased by two percent (2.00%) of the amount in effect the prior Fiscal Year.

**2. Undeveloped Property**

The Assigned Annual Special Tax rate in Fiscal Year 2006-07 for an Assessor's Parcel classified as Undeveloped Property shall be \$25,018.20 per acre of Acreage.

Each July 1, commencing July 1, 2007, the Assigned Annual Special Tax per acre of Acreage for each Assessor's Parcel of Undeveloped Property shall be increased by two percent (2.00%) of the amount in effect the prior Fiscal Year.

**SECTION E  
BACKUP ANNUAL SPECIAL TAXES**

Each Fiscal Year, each Assessor's Parcel of Developed Property shall be subject to a Backup Annual Special Tax. The Backup Annual Special Tax rate for an Assessor's Parcel of Developed Property within a Final Subdivision Map in Fiscal Year 2006-07 or such later Fiscal Year in which such Final Subdivision Map is created shall be the rate per Lot calculated according to the following formula:

$$B = \frac{U \times A}{L}$$

The terms above have the following meanings:

- B = Backup Annual Special Tax per Lot
- U = Assigned Annual Special Tax per acre of Acreage for Undeveloped Property in the Fiscal Year which the calculation is performed
- A = Acreage of Taxable Property in such Final Subdivision Map at time of calculation, as determined by the Board pursuant to Section K
- L = Lots in the Final Subdivision Map at the time of calculation

Each July 1, commencing the July 1 first following the initial calculation of the Backup Annual Special Tax rate for an Assessor's Parcel of Developed Property with a Final Subdivision Map, the Backup Annual Special Tax for each Lot within such Final Subdivision Map shall be increased by two percent (2.00%) of the amount in effect the prior Fiscal Year.

Notwithstanding the foregoing, if all or any portion of the Final Subdivision Map(s) described in the preceding paragraph is subsequently changed or modified, then the Backup Annual Special Tax for each Assessor's Parcel of Developed Property in such Final Subdivision Map that is changed or modified shall be a rate per square foot of Acreage calculated as follows:

1. Determine the total Backup Annual Special Taxes anticipated to apply to the changed or modified area in the Final Subdivision Map prior to the change or modification in the current Fiscal Year.

2. The result of paragraph 1 above shall be divided by the Acreage of Taxable Property which is ultimately expected to exist in such changed or modified area in the Final Subdivision Map, as reasonably determined by the Board.
3. The result of paragraph 2 above shall be divided by 43,560. The result is the Backup Annual Special Tax per square foot of Acreage which shall be applicable to Assessor's Parcels of Developed Property in such changed or modified area of the Final Subdivision Map. Each July 1, commencing the July 1 first following the change or modification to be Final Subdivision Map the amount determined by this Section shall be increased by two percent (2.00%) of the amount in effect the prior Fiscal Year.

## **SECTION F METHOD OF APPORTIONMENT OF THE ANNUAL SPECIAL TAX**

Commencing Fiscal Year 2006-07, and for each subsequent Fiscal Year, the Board shall levy Annual Special Taxes as follows:

Step One: The Board shall levy an Annual Special Tax on each Assessor's Parcel of Developed Property in an amount equal to the Assigned Annual Special Tax applicable to each such Assessor's Parcel.

Step Two: If the sum of the amounts collected in step one is insufficient to satisfy the Minimum Annual Special Tax Requirement, then the Board shall Proportionately levy an Annual Special Tax on each Assessor's Parcel of Undeveloped Property up to the Assigned Annual Special Tax applicable to each such Assessor's Parcel to satisfy the Minimum Annual Special Tax Requirement.

Step Three: If the sum of the amounts collected in steps one and two is insufficient to satisfy the Minimum Annual Special Tax Requirement, then the Board shall Proportionately levy an Annual Special Tax on each Assessor's Parcel of Developed Property up to the Maximum Special Tax applicable to each such Assessor's Parcel to satisfy the Minimum Annual Special Tax Requirement.

## **SECTION G PREPAYMENT OF ANNUAL SPECIAL TAXES**

The Annual Special Tax obligation of an Assessor's Parcel of Developed Property, or an Assessor's Parcel of Undeveloped Property for which a Building Permit has been issued, may be prepaid in full provided that there are no delinquent Special Taxes, penalties, or interest charges outstanding with respect to such Assessor's Parcel at the time the Annual Special Tax obligation would be prepaid. The Prepayment Amount for an Assessor's Parcel eligible for prepayment shall be determined as described below.

An owner of an Assessor's Parcel intending to prepay the Annual Special Tax obligation shall provide IA No. A of CFD No. 14 with written notice of intent to prepay. Within thirty (30) days of receipt of such written notice, the Board shall reasonably determine the Prepayment Amount of such Assessor's Parcel and shall notify such owner of such Prepayment Amount. The Prepayment Amount shall be calculated according to the following formula:

$$P = PVT - RFC + PAF$$

The terms above have the following meanings:

P	=	Prepayment Amount
PVT	=	Present Value of Taxes
RFC	=	Reserve Fund Credit
PAF	=	Prepayment Administrative Fees

Notwithstanding the foregoing, no prepayment will be allowed unless the amount of Annual Special Taxes that may be levied on Taxable Property, net of Administrative Expenses, shall be at least 1.1 times the regularly scheduled annual interest and principal payments on all currently outstanding Bonds in each future Fiscal Year and such prepayment will not impair the security of all currently outstanding Bonds, as reasonably determined by the Board. Such determination shall include identifying all Assessor's Parcels that are expected to become Exempt Property.

With respect to any Assessor's Parcel that is prepaid, the Board shall indicate in the records of IA No. A of CFD No. 14 that there has been a prepayment of the Annual Special Tax obligation and shall cause a suitable notice to be recorded in compliance with the Act to indicate the prepayment of the Annual Special Tax obligation and the release of the Annual Special Tax lien on such Assessor's Parcel, and the obligation of such Assessor's Parcel to pay such Annual Special Tax shall cease.

## **SECTION H PARTIAL PREPAYMENT OF ANNUAL SPECIAL TAXES**

The Annual Special Tax obligation of an Assessor's Parcel may be partially prepaid at the times and under the conditions set forth in this section, provided that there are no delinquent Special Taxes, penalties, or interest charges outstanding with respect to such Assessor's Parcel at the time the Annual Special Tax obligation would be prepaid.

### **1. Partial Prepayment Times and Conditions**

Prior to the conveyance of the first production Unit on a Lot within a Final Subdivision Map to a Homeowner, the owner of no less than all the Taxable Property within such Final Subdivision Map may elect in writing to the Board to prepay a portion of the Annual Special Tax obligations for all the Assessor's Parcels within such Final Subdivision Map, as calculated in Section H.2. below. The partial prepayment of each Annual Special Tax obligation shall be collected for all Assessor's Parcels prior to the conveyance of the first production Unit to a Homeowner with respect to such Final Subdivision Map.

### **2. Partial Prepayment Amount**

The Partial Prepayment Amount shall be calculated according to the following formula:

$$PP = P_G \times F$$

The terms above have the following meanings:

- PP = the Partial Prepayment Amount
- P<sub>G</sub> = the Prepayment Amount calculated according to Section G
- F = the percent by which the owner of the Assessor's Parcel is partially prepaying the Annual Special Tax obligation

### **3. Partial Prepayment Procedures and Limitations**

With respect to any Assessor's Parcel that is partially prepaid, the Board shall indicate in the records of IA No. A of CFD No. 14 that there has been a partial prepayment of the Annual Special Tax obligation and shall cause a suitable notice to be recorded in compliance with the Act to indicate the partial prepayment of the Annual Special Tax obligation and the partial release of the Annual Special Tax lien on such Assessor's Parcel, and the obligation of such Assessor's Parcel to pay such prepaid portion of the Annual Special Tax shall cease. Additionally, the notice shall indicate that the Assigned Annual Special Tax and the Backup Annual Special Tax if applicable for the Assessor's Parcel has been reduced by an amount equal to the percentage which was partially prepaid.

Notwithstanding the foregoing, no partial prepayment will be allowed unless the amount of Annual Special Taxes that may be levied on Taxable Property after such partial prepayment, net of Administrative Expenses, shall be at least 1.1 times the regularly scheduled annual interest and principal payments on all currently outstanding Bonds in each future Fiscal Year and such partial prepayment will not impair the security of all currently outstanding Bonds, as reasonably determined by the Board. Such determination shall include identifying all Assessor's Parcels that are expected to become Exempt Property.

## **SECTION I EXCESS ASSIGNED ANNUAL SPECIAL TAXES**

In any Fiscal Year which the Annual Special Taxes collected from Developed Property, pursuant to Step 1 of Section F, exceeds the Minimum Annual Special Tax Requirement, the School District shall use such amount for acquisition, construction or financing of school facilities in accordance with the Act, IA No. A of CFD No. 14 proceedings and other applicable laws as determined by the Board.

## **SECTION J TERMINATION OF SPECIAL TAX**

Annual Special Taxes shall be levied for a period of thirty-five (35) Fiscal Years after the last series of Bonds have been issued, provided that Annual Special Taxes shall not be levied after Fiscal Year 2050-2051.

**SECTION K  
EXEMPTIONS**

The Board shall classify as Exempt Property (i) Assessor's Parcels owned by the State of California, Federal or other local governments, (ii) Assessor's Parcels which are used as places of worship and are exempt from *ad valorem* property taxes because they are owned by a religious organization, (iii) Assessor's Parcels owned by a homeowners' association, (iv) Assessor's Parcels with public or utility easements making impractical their utilization for other than the purposes set forth in the easement, (v) Assessor's Parcels developed or expected to be developed exclusively for non-residential use, including any use directly servicing any non-residential property, such as parking, as reasonably determined by the Board, and (vi) any other Assessor's Parcels at the reasonable discretion of the Board, provided that no such classification would reduce the Net Taxable Acreage to less than the Minimum Taxable Acreage listed in Table 3 below. Notwithstanding the above, the Board shall not classify an Assessor's Parcel as Exempt Property if such classification would reduce the sum of all Taxable Property to less than the Minimum Taxable Acreage. Assessor's Parcels which cannot be classified as Exempt Property because such classification would reduce the Acreage of all Taxable Property to less than the Minimum Taxable Acreage will continue to be classified as Developed Property or Undeveloped Property, as applicable, and will continue to be subject to Special Taxes accordingly.

**TABLE 3**

**MINIMUM TAXABLE ACREAGE**

Taxable Acres
123.76 Acres

**SECTION L  
APPEALS**

Any property owner claiming that the amount or application of the Special Tax is not correct may file a written notice of appeal with the Board not later than twelve months after having paid the first installment of the Special Tax that is disputed. In order to be considered sufficient, any notice of appeal must: (i) specifically identify the property by address and Assessor's Parcel Number; (ii) state the amount in dispute and whether it is the whole amount or only a portion of the Special Tax; (iii) state all grounds on which the property owner is disputing the amount or application of the Special Tax, including a reasonably detailed explanation as to why the amount or application of such Special Tax is incorrect; (iv) include all documentation, if any, in support of the claim; and (v) be verified under penalty of perjury by the person who paid the Special Tax or his or her guardian, executor or administrator. A representative(s) of IA No. A of CFD No. 14 shall promptly review the appeal, and if necessary, meet with the property owner, consider written and oral evidence regarding the amount of the Special Tax, and rule on the appeal. If the representative's decision requires that the Special Tax for an Assessor's Parcel be modified or changed in favor of the property owner, a cash refund shall not be made (except for the last year of levy), but an adjustment shall be made to the Annual Special Tax on that Assessor's Parcel in the subsequent Fiscal Year(s) as the representative's decision shall indicate.

**SECTION M**  
**MANNER OF COLLECTION**

The Annual Special Tax shall be collected in the same manner and at the same time as ordinary *ad valorem* property taxes and shall be subject to the same penalties, the same procedure, sale and lien priority in the case of delinquency; provided, however, that IA No. A of CFD No. 14 may directly bill the Special Tax, may collect Special Taxes at a different time or in a different manner if necessary to meet its financial obligations, and if so collected, a delinquent penalty of 10% of the Special Tax will attach at 5:00 p.m. on the date the Special Tax becomes delinquent and interest at 1.5% per month of the Special Tax will attach on the July 1 after the delinquency date and the first of each month thereafter until such Special Taxes are paid.

J:\CLIENTS\POWAY.USD\Del Sur\RMA\_DelSur\_11.29.05.doc

**EXHIBIT A**  
**CFD BOUNDARY MAP**

PROPOSED BOUNDARIES OF  
 POWAY UNIFIED SCHOOL DISTRICT  
 IMPROVEMENT AREA NO. A OF  
 COMMUNITY FACILITIES DISTRICT NO. 14  
 SAN DIEGO COUNTY  
 STATE OF CALIFORNIA

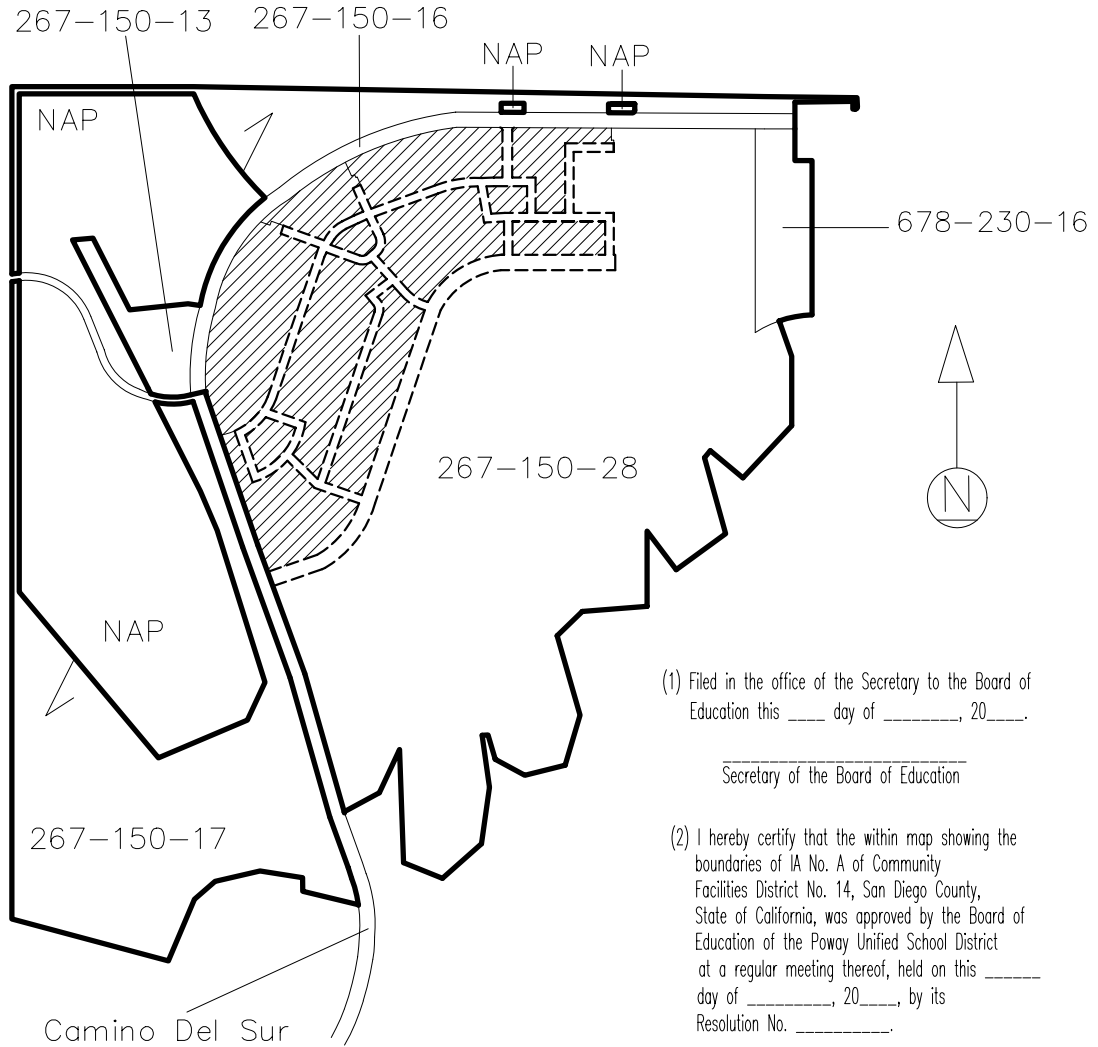

(1) Filed in the office of the Secretary to the Board of Education this \_\_\_\_ day of \_\_\_\_\_, 20\_\_\_\_.

\_\_\_\_\_  
 Secretary of the Board of Education

(2) I hereby certify that the within map showing the boundaries of IA No. A of Community Facilities District No. 14, San Diego County, State of California, was approved by the Board of Education of the Poway Unified School District at a regular meeting thereof, held on this \_\_\_\_ day of \_\_\_\_\_, 20\_\_\_\_, by its Resolution No. \_\_\_\_\_.

\_\_\_\_\_  
 Secretary of the Board of Education

(3) Filed this \_\_\_\_ day of \_\_\_\_\_, 20\_\_\_\_, at the hour of \_\_\_\_ o'clock \_\_m, in Book \_\_\_\_\_ of Maps of Assessment and Community Facilities Districts at page \_\_\_\_\_ and as Instrument No. \_\_\_\_\_, in the office of the County Recorder of San Diego County, State of California.

\_\_\_\_\_  
 County Recorder of San Diego County

Reference is hereby made to the Assessor maps of the County of San Diego for an exact description of the lines and dimensions of each lot and parcel.

LEGEND

	Boundaries of IA No. A of Community Facilities District No. 14
	Road Easements (Not a part of IA No. A of CFD No. 14)
	Assessor's Parcel Line
	San Diego County Assessor's Parcel Number
	Not a Part of IA No. A of CFD No. 14
	Exhibit A



EXHIBIT "A"  
BOUNDARIES OF  
POWAY UNIFIED SCHOOL DISTRICT  
IMPROVEMENT AREA NO. A OF  
COMMUNITY FACILITIES DISTRICT NO. 14

Assessor's Parcel Numbers\*

267-150-20  
267-150-21  
267-150-22  
267-150-23  
267-150-24  
267-150-25  
267-230-01  
267-230-02  
267-230-03  
267-230-04  
267-230-05  
267-230-06  
267-230-07

\*Current as of equalized  
tax Role of the Assesor of  
the County of San Diego  
for Fiscal Year 2005-06

**Exhibit B**

**Summary of Transactions for Funds and Accounts**

## SOURCES AND USES OF FUNDS

Jul 1 2012 - Apr 30 2013

Account Name	SOURCES				USES							Ending Balance	
	Beginning Balance	Special Tax Receipts	Investment Earnings	Miscellaneous	Total Sources	Interest Payments	Principal Payments	Acquisition/ Construction Payments	Legal/ Consulting/ Services	Miscellaneous	Total Uses		Transfer
Administration Expense Fund	\$118,325.27	\$0.00	\$10.25	\$0.00	\$10.25	\$0.00	\$0.00	\$0.00	(\$25,000.00)	\$0.00	(\$25,000.00)	\$57,434.28	\$150,769.80
CalTrans Improvement Account	\$12,193.19	\$0.00	\$0.99	\$0.00	\$0.99	\$0.00	\$0.00	\$0.00	\$0.00	\$0.00	\$0.00	\$0.00	\$12,194.18
City Facilities Account	\$1.73	\$0.00	\$0.00	\$0.00	\$0.00	\$0.00	\$0.00	\$0.00	\$0.00	\$0.00	\$0.00	\$0.00	\$1.73
Interest Account	\$0.00	\$0.00	\$0.00	\$0.00	\$0.00	(\$2,605,185.00)	\$0.00	\$0.00	\$0.00	\$0.00	(\$2,605,185.00)	\$2,605,425.30	\$240.30
Letter of Credit Fund	\$0.00	\$0.00	\$0.00	\$0.00	\$0.00	\$0.00	\$0.00	\$0.00	\$0.00	\$0.00	\$0.00	\$0.00	\$0.00
LOC WL Home/Bay Laing 3C	\$128,996.34	\$0.00	\$9.82	\$0.00	\$9.82	\$0.00	\$0.00	\$0.00	\$0.00	\$0.00	\$0.00	\$0.00	\$129,006.16
Principal Account	\$0.00	\$0.00	\$0.00	\$0.00	\$0.00	\$0.00	(\$395,000.00)	\$0.00	\$0.00	\$0.00	(\$395,000.00)	\$395,000.00	\$0.00
Reserve Fund	\$4,823,093.54	\$0.00	\$403.06	\$0.00	\$403.06	\$0.00	\$0.00	\$0.00	\$0.00	\$0.00	\$0.00	\$23,307.07	\$4,846,803.67
Shea Cash Deposit 5A	\$156,993.02	\$0.00	\$13.05	\$0.00	\$13.05	\$0.00	\$0.00	\$0.00	\$0.00	\$0.00	\$0.00	\$0.00	\$157,006.07
Shea Cash Deposit 9C	\$0.00	\$0.00	\$0.00	\$0.00	\$0.00	\$0.00	\$0.00	\$0.00	\$0.00	\$0.00	\$0.00	\$0.00	\$0.00
Special Tax Fund	\$1,816,929.06	\$2,283,201.38	\$85.47	\$0.00	\$2,283,286.85	\$0.00	\$0.00	\$0.00	\$0.00	\$0.00	\$0.00	(\$3,081,166.65)	\$1,019,049.26
<b>Total:</b>	<b>\$7,056,532.15</b>	<b>\$2,283,201.38</b>	<b>\$522.64</b>	<b>\$0.00</b>	<b>\$2,283,724.02</b>	<b>(\$2,605,185.00)</b>	<b>(\$395,000.00)</b>	<b>\$0.00</b>	<b>(\$25,000.00)</b>	<b>\$0.00</b>	<b>(\$3,025,185.00)</b>	<b>\$0.00</b>	<b>\$6,315,071.17</b>

\$57,434.28 in Special Taxes was transferred from the Special Tax Fund to Administrative Expense Fund to meet the annual administrative expense requirement pursuant to the Bond Indenture.

\$395,000.00 was paid in Interest from the Interest Account for the September debt service obligation.

\$240.30 in Reserve Fund excess was transferred from the Reserve Fund to the Interest Account for the March debt service obligation pursuant to the Bond Indenture.

\$23,547.37 was transferred from the Special Tax Fund to the Reserve Fund to meet the Reserve Requirement pursuant to the Bond Indenture.

\$1,306,937.50 was paid in Interest from the Interest Account for the September debt service obligation.

\$1,298,247.50 was paid in Interest from the Interest Account for the March debt service obligation.

## SOURCES AND USES OF FUNDS

07/01/2012

Account Name	SOURCES				USES							Transfer	Ending Balance
	Beginning Balance	Special Tax Receipts	Investment Earnings	Miscellaneous	Total Sources	Interest Payments	Principal Payments	Acquisition/ Construction Payments	Legal/ Consulting/ Services	Miscellaneous	Total Uses		
Administration Expense Fund	\$118,325.27	\$0.00	\$0.99	\$0.00	\$0.99	\$0.00	\$0.00	\$0.00	(\$6,250.00)	\$0.00	(\$6,250.00)	\$0.00	\$112,076.26
CalTrans Improvement Account	\$12,193.19	\$0.00	\$0.10	\$0.00	\$0.10	\$0.00	\$0.00	\$0.00	\$0.00	\$0.00	\$0.00	\$0.00	\$12,193.29
City Facilities Account	\$1.73	\$0.00	\$0.00	\$0.00	\$0.00	\$0.00	\$0.00	\$0.00	\$0.00	\$0.00	\$0.00	\$0.00	\$1.73
Interest Account	\$0.00	\$0.00	\$0.00	\$0.00	\$0.00	\$0.00	\$0.00	\$0.00	\$0.00	\$0.00	\$0.00	\$0.00	\$0.00
Letter of Credit Fund	\$0.00	\$0.00	\$0.00	\$0.00	\$0.00	\$0.00	\$0.00	\$0.00	\$0.00	\$0.00	\$0.00	\$0.00	\$0.00
LOC WL Home/Bay Laing 3C	\$128,996.34	\$0.00	\$0.11	\$0.00	\$0.11	\$0.00	\$0.00	\$0.00	\$0.00	\$0.00	\$0.00	\$0.00	\$128,996.45
Principal Account	\$0.00	\$0.00	\$0.00	\$0.00	\$0.00	\$0.00	\$0.00	\$0.00	\$0.00	\$0.00	\$0.00	\$0.00	\$0.00
Reserve Fund	\$4,823,093.54	\$0.00	\$39.65	\$0.00	\$39.65	\$0.00	\$0.00	\$0.00	\$0.00	\$0.00	\$0.00	\$0.00	\$4,823,133.19
Shea Cash Deposit 5A	\$156,993.02	\$0.00	\$1.29	\$0.00	\$1.29	\$0.00	\$0.00	\$0.00	\$0.00	\$0.00	\$0.00	\$0.00	\$156,994.31
Shea Cash Deposit 9C	\$0.00	\$0.00	\$0.00	\$0.00	\$0.00	\$0.00	\$0.00	\$0.00	\$0.00	\$0.00	\$0.00	\$0.00	\$0.00
Special Tax Fund	\$1,816,929.06	\$10,388.28	\$14.86	\$0.00	\$10,403.14	\$0.00	\$0.00	\$0.00	\$0.00	\$0.00	\$0.00	\$0.00	\$1,827,332.20
<b>Total:</b>	\$7,056,532.15	\$10,388.28	\$57.00	\$0.00	\$10,445.28	\$0.00	\$0.00	\$0.00	(\$6,250.00)	\$0.00	(\$6,250.00)	\$0.00	\$7,060,727.43

## SOURCES AND USES OF FUNDS

08/01/2012

Account Name	SOURCES				USES							Ending Balance	
	Beginning Balance	Special Tax Receipts	Investment Earnings	Miscellaneous	Total Sources	Interest Payments	Principal Payments	Acquisition/ Construction Payments	Legal/ Consulting/ Services	Miscellaneous	Total Uses		Transfer
Administration Expense Fund	\$112,076.26	\$0.00	\$0.98	\$0.00	\$0.98	\$0.00	\$0.00	\$0.00	\$0.00	\$0.00	\$0.00	\$0.00	\$112,077.24
CalTrans Improvement Account	\$12,193.29	\$0.00	\$0.10	\$0.00	\$0.10	\$0.00	\$0.00	\$0.00	\$0.00	\$0.00	\$0.00	\$0.00	\$12,193.39
City Facilities Account	\$1.73	\$0.00	\$0.00	\$0.00	\$0.00	\$0.00	\$0.00	\$0.00	\$0.00	\$0.00	\$0.00	\$0.00	\$1.73
Interest Account	\$0.00	\$0.00	\$0.00	\$0.00	\$0.00	\$0.00	\$0.00	\$0.00	\$0.00	\$0.00	\$0.00	\$0.00	\$0.00
Letter of Credit Fund	\$0.00	\$0.00	\$0.00	\$0.00	\$0.00	\$0.00	\$0.00	\$0.00	\$0.00	\$0.00	\$0.00	\$0.00	\$0.00
LOC WL Home/Bay Laing 3C	\$128,996.45	\$0.00	\$1.10	\$0.00	\$1.10	\$0.00	\$0.00	\$0.00	\$0.00	\$0.00	\$0.00	\$0.00	\$128,997.55
Principal Account	\$0.00	\$0.00	\$0.00	\$0.00	\$0.00	\$0.00	\$0.00	\$0.00	\$0.00	\$0.00	\$0.00	\$0.00	\$0.00
Reserve Fund	\$4,823,133.19	\$0.00	\$40.97	\$0.00	\$40.97	\$0.00	\$0.00	\$0.00	\$0.00	\$0.00	\$0.00	\$0.00	\$4,823,174.16
Shea Cash Deposit 5A	\$156,994.31	\$0.00	\$1.33	\$0.00	\$1.33	\$0.00	\$0.00	\$0.00	\$0.00	\$0.00	\$0.00	\$0.00	\$156,995.64
Shea Cash Deposit 9C	\$0.00	\$0.00	\$0.00	\$0.00	\$0.00	\$0.00	\$0.00	\$0.00	\$0.00	\$0.00	\$0.00	\$0.00	\$0.00
Special Tax Fund	\$1,827,332.20	\$1,637.79	\$15.47	\$0.00	\$1,653.26	\$0.00	\$0.00	\$0.00	\$0.00	\$0.00	\$0.00	\$0.00	\$1,828,985.46
<b>Total:</b>	<b>\$7,060,727.43</b>	<b>\$1,637.79</b>	<b>\$59.95</b>	<b>\$0.00</b>	<b>\$1,697.74</b>	<b>\$0.00</b>	<b>\$0.00</b>	<b>\$0.00</b>	<b>\$0.00</b>	<b>\$0.00</b>	<b>\$0.00</b>	<b>\$0.00</b>	<b>\$7,062,425.17</b>

## SOURCES AND USES OF FUNDS

09/01/2012

Account Name	SOURCES				USES							Ending Balance	
	Beginning Balance	Special Tax Receipts	Investment Earnings	Miscellaneous	Total Sources	Interest Payments	Principal Payments	Acquisition/ Construction Payments	Legal/ Consulting/ Services	Miscellaneous	Total Uses		Transfer
Administration Expense Fund	\$112,077.24	\$0.00	\$0.95	\$0.00	\$0.95	\$0.00	\$0.00	\$0.00	\$0.00	\$0.00	\$0.00	\$0.00	\$112,078.19
CalTrans Improvement Account	\$12,193.39	\$0.00	\$0.10	\$0.00	\$0.10	\$0.00	\$0.00	\$0.00	\$0.00	\$0.00	\$0.00	\$0.00	\$12,193.49
City Facilities Account	\$1.73	\$0.00	\$0.00	\$0.00	\$0.00	\$0.00	\$0.00	\$0.00	\$0.00	\$0.00	\$0.00	\$0.00	\$1.73
Interest Account	\$0.00	\$0.00	\$0.00	\$0.00	\$0.00	(\$1,306,937.50)	\$0.00	\$0.00	\$0.00	\$0.00	(\$1,306,937.50)	\$1,306,937.50	\$0.00
Letter of Credit Fund	\$0.00	\$0.00	\$0.00	\$0.00	\$0.00	\$0.00	\$0.00	\$0.00	\$0.00	\$0.00	\$0.00	\$0.00	\$0.00
LOC WL Home/Bay Laing 3C	\$128,997.55	\$0.00	\$1.10	\$0.00	\$1.10	\$0.00	\$0.00	\$0.00	\$0.00	\$0.00	\$0.00	\$0.00	\$128,998.65
Principal Account	\$0.00	\$0.00	\$0.00	\$0.00	\$0.00	\$0.00	(\$395,000.00)	\$0.00	\$0.00	\$0.00	(\$395,000.00)	\$395,000.00	\$0.00
Reserve Fund	\$4,823,174.16	\$0.00	\$40.97	\$0.00	\$40.97	\$0.00	\$0.00	\$0.00	\$0.00	\$0.00	\$0.00	\$23,547.37	\$4,846,762.50
Shea Cash Deposit 5A	\$156,995.64	\$0.00	\$1.33	\$0.00	\$1.33	\$0.00	\$0.00	\$0.00	\$0.00	\$0.00	\$0.00	\$0.00	\$156,996.97
Shea Cash Deposit 9C	\$0.00	\$0.00	\$0.00	\$0.00	\$0.00	\$0.00	\$0.00	\$0.00	\$0.00	\$0.00	\$0.00	\$0.00	\$0.00
Special Tax Fund	\$1,828,985.46	\$4,967.44	\$15.53	\$0.00	\$4,982.97	\$0.00	\$0.00	\$0.00	\$0.00	\$0.00	\$0.00	(\$1,725,484.87)	\$108,483.56
<b>Total:</b>	<b>\$7,062,425.17</b>	<b>\$4,967.44</b>	<b>\$59.98</b>	<b>\$0.00</b>	<b>\$5,027.42</b>	<b>(\$1,306,937.50)</b>	<b>(\$395,000.00)</b>	<b>\$0.00</b>	<b>\$0.00</b>	<b>\$0.00</b>	<b>(\$1,701,937.50)</b>	<b>\$0.00</b>	<b>\$5,365,515.09</b>

\$395,000.00 was paid in Interest from the Interest Account for the September debt service obligation.

\$23,547.37 was transferred from the Special Tax Fund to the Reserve Fund to meet the Reserve Requirement pursuant to the Bond Indenture.

\$1,306,937.50 was paid in Interest from the Interest Account for the September debt service obligation.

## SOURCES AND USES OF FUNDS

10/01/2012

Account Name	SOURCES				USES							Transfer	Ending Balance
	Beginning Balance	Special Tax Receipts	Investment Earnings	Miscellaneous	Total Sources	Interest Payments	Principal Payments	Acquisition/ Construction Payments	Legal/ Consulting/ Services	Miscellaneous	Total Uses		
Administration Expense Fund	\$112,078.19	\$0.00	\$0.92	\$0.00	\$0.92	\$0.00	\$0.00	\$0.00	(\$6,250.00)	\$0.00	(\$6,250.00)	\$0.00	\$105,829.11
CalTrans Improvement Account	\$12,193.49	\$0.00	\$0.10	\$0.00	\$0.10	\$0.00	\$0.00	\$0.00	\$0.00	\$0.00	\$0.00	\$0.00	\$12,193.59
City Facilities Account	\$1.73	\$0.00	\$0.00	\$0.00	\$0.00	\$0.00	\$0.00	\$0.00	\$0.00	\$0.00	\$0.00	\$0.00	\$1.73
Interest Account	\$0.00	\$0.00	\$0.00	\$0.00	\$0.00	\$0.00	\$0.00	\$0.00	\$0.00	\$0.00	\$0.00	\$0.00	\$0.00
Letter of Credit Fund	\$0.00	\$0.00	\$0.00	\$0.00	\$0.00	\$0.00	\$0.00	\$0.00	\$0.00	\$0.00	\$0.00	\$0.00	\$0.00
LOC WL Home/Bay Laing 3C	\$128,998.65	\$0.00	\$1.06	\$0.00	\$1.06	\$0.00	\$0.00	\$0.00	\$0.00	\$0.00	\$0.00	\$0.00	\$128,999.71
Principal Account	\$0.00	\$0.00	\$0.00	\$0.00	\$0.00	\$0.00	\$0.00	\$0.00	\$0.00	\$0.00	\$0.00	\$0.00	\$0.00
Reserve Fund	\$4,846,762.50	\$0.00	\$39.76	\$0.00	\$39.76	\$0.00	\$0.00	\$0.00	\$0.00	\$0.00	\$0.00	\$0.00	\$4,846,802.26
Shea Cash Deposit 5A	\$156,996.97	\$0.00	\$1.29	\$0.00	\$1.29	\$0.00	\$0.00	\$0.00	\$0.00	\$0.00	\$0.00	\$0.00	\$156,998.26
Shea Cash Deposit 9C	\$0.00	\$0.00	\$0.00	\$0.00	\$0.00	\$0.00	\$0.00	\$0.00	\$0.00	\$0.00	\$0.00	\$0.00	\$0.00
Special Tax Fund	\$108,483.56	\$0.00	\$2.36	\$0.00	\$2.36	\$0.00	\$0.00	\$0.00	\$0.00	\$0.00	\$0.00	\$0.00	\$108,485.92
<b>Total:</b>	<b>\$5,365,515.09</b>	<b>\$0.00</b>	<b>\$45.49</b>	<b>\$0.00</b>	<b>\$45.49</b>	<b>\$0.00</b>	<b>\$0.00</b>	<b>\$0.00</b>	<b>(\$6,250.00)</b>	<b>\$0.00</b>	<b>(\$6,250.00)</b>	<b>\$0.00</b>	<b>\$5,359,310.58</b>

## SOURCES AND USES OF FUNDS

11/01/2012

Account Name	SOURCES				USES							Ending Balance	
	Beginning Balance	Special Tax Receipts	Investment Earnings	Miscellaneous	Total Sources	Interest Payments	Principal Payments	Acquisition/ Construction Payments	Legal/ Consulting/ Services	Miscellaneous	Total Uses		Transfer
Administration Expense Fund	\$105,829.11	\$0.00	\$0.92	\$0.00	\$0.92	\$0.00	\$0.00	\$0.00	\$0.00	\$0.00	\$0.00	\$0.00	\$105,830.03
CalTrans Improvement Account	\$12,193.59	\$0.00	\$0.10	\$0.00	\$0.10	\$0.00	\$0.00	\$0.00	\$0.00	\$0.00	\$0.00	\$0.00	\$12,193.69
City Facilities Account	\$1.73	\$0.00	\$0.00	\$0.00	\$0.00	\$0.00	\$0.00	\$0.00	\$0.00	\$0.00	\$0.00	\$0.00	\$1.73
Interest Account	\$0.00	\$0.00	\$0.00	\$0.00	\$0.00	\$0.00	\$0.00	\$0.00	\$0.00	\$0.00	\$0.00	\$0.00	\$0.00
Letter of Credit Fund	\$0.00	\$0.00	\$0.00	\$0.00	\$0.00	\$0.00	\$0.00	\$0.00	\$0.00	\$0.00	\$0.00	\$0.00	\$0.00
LOC WL Home/Bay Laing 3C	\$128,999.71	\$0.00	\$1.10	\$0.00	\$1.10	\$0.00	\$0.00	\$0.00	\$0.00	\$0.00	\$0.00	\$0.00	\$129,000.81
Principal Account	\$0.00	\$0.00	\$0.00	\$0.00	\$0.00	\$0.00	\$0.00	\$0.00	\$0.00	\$0.00	\$0.00	\$0.00	\$0.00
Reserve Fund	\$4,846,802.26	\$0.00	\$41.17	\$0.00	\$41.17	\$0.00	\$0.00	\$0.00	\$0.00	\$0.00	\$0.00	\$0.00	\$4,846,843.43
Shea Cash Deposit 5A	\$156,998.26	\$0.00	\$1.33	\$0.00	\$1.33	\$0.00	\$0.00	\$0.00	\$0.00	\$0.00	\$0.00	\$0.00	\$156,999.59
Shea Cash Deposit 9C	\$0.00	\$0.00	\$0.00	\$0.00	\$0.00	\$0.00	\$0.00	\$0.00	\$0.00	\$0.00	\$0.00	\$0.00	\$0.00
Special Tax Fund	\$108,485.92	\$77,265.62	\$0.92	\$0.00	\$77,266.54	\$0.00	\$0.00	\$0.00	\$0.00	\$0.00	\$0.00	\$0.00	\$185,752.46
<b>Total:</b>	<b>\$5,359,310.58</b>	<b>\$77,265.62</b>	<b>\$45.54</b>	<b>\$0.00</b>	<b>\$77,311.16</b>	<b>\$0.00</b>	<b>\$0.00</b>	<b>\$0.00</b>	<b>\$0.00</b>	<b>\$0.00</b>	<b>\$0.00</b>	<b>\$0.00</b>	<b>\$5,436,621.74</b>



## SOURCES AND USES OF FUNDS

12/01/2012

Account Name	SOURCES				USES							Transfer	Ending Balance	
	Beginning Balance	Special Tax Receipts	Investment Earnings	Miscellaneous	Total Sources	Interest Payments	Principal Payments	Acquisition/ Construction Payments	Legal/ Consulting/ Services	Miscellaneous	Total Uses			
Administration Expense Fund	\$105,830.03	\$0.00	\$0.87	\$0.00	\$0.87	\$0.00	\$0.00	\$0.00	\$0.00	\$0.00	\$0.00	\$0.00	\$0.00	\$105,830.90
CalTrans Improvement Account	\$12,193.69	\$0.00	\$0.10	\$0.00	\$0.10	\$0.00	\$0.00	\$0.00	\$0.00	\$0.00	\$0.00	\$0.00	\$0.00	\$12,193.79
City Facilities Account	\$1.73	\$0.00	\$0.00	\$0.00	\$0.00	\$0.00	\$0.00	\$0.00	\$0.00	\$0.00	\$0.00	\$0.00	\$0.00	\$1.73
Interest Account	\$0.00	\$0.00	\$0.00	\$0.00	\$0.00	\$0.00	\$0.00	\$0.00	\$0.00	\$0.00	\$0.00	\$0.00	\$0.00	\$0.00
Letter of Credit Fund	\$0.00	\$0.00	\$0.00	\$0.00	\$0.00	\$0.00	\$0.00	\$0.00	\$0.00	\$0.00	\$0.00	\$0.00	\$0.00	\$0.00
LOC WL Home/Bay Laing 3C	\$129,000.81	\$0.00	\$1.06	\$0.00	\$1.06	\$0.00	\$0.00	\$0.00	\$0.00	\$0.00	\$0.00	\$0.00	\$0.00	\$129,001.87
Principal Account	\$0.00	\$0.00	\$0.00	\$0.00	\$0.00	\$0.00	\$0.00	\$0.00	\$0.00	\$0.00	\$0.00	\$0.00	\$0.00	\$0.00
Reserve Fund	\$4,846,843.43	\$0.00	\$39.84	\$0.00	\$39.84	\$0.00	\$0.00	\$0.00	\$0.00	\$0.00	\$0.00	\$0.00	\$0.00	\$4,846,883.27
Shea Cash Deposit 5A	\$156,999.59	\$0.00	\$1.29	\$0.00	\$1.29	\$0.00	\$0.00	\$0.00	\$0.00	\$0.00	\$0.00	\$0.00	\$0.00	\$157,000.88
Shea Cash Deposit 9C	\$0.00	\$0.00	\$0.00	\$0.00	\$0.00	\$0.00	\$0.00	\$0.00	\$0.00	\$0.00	\$0.00	\$0.00	\$0.00	\$0.00
Special Tax Fund	\$185,752.46	\$766,168.89	\$1.38	\$0.00	\$766,170.27	\$0.00	\$0.00	\$0.00	\$0.00	\$0.00	\$0.00	\$0.00	\$0.00	\$951,922.73
<b>Total:</b>	\$5,436,621.74	\$766,168.89	\$44.54	\$0.00	\$766,213.43	\$0.00	\$0.00	\$0.00	\$0.00	\$0.00	\$0.00	\$0.00	\$0.00	\$6,202,835.17

## SOURCES AND USES OF FUNDS

01/01/2013

Account Name	SOURCES				USES							Ending Balance	
	Beginning Balance	Special Tax Receipts	Investment Earnings	Miscellaneous	Total Sources	Interest Payments	Principal Payments	Acquisition/Construction Payments	Legal/Consulting/Services	Miscellaneous	Total Uses		Transfer
Administration Expense Fund	\$105,830.90	\$0.00	\$0.90	\$0.00	\$0.90	\$0.00	\$0.00	\$0.00	(\$6,250.00)	\$0.00	(\$6,250.00)	\$57,434.28	\$157,016.08
CalTrans Improvement Account	\$12,193.79	\$0.00	\$0.10	\$0.00	\$0.10	\$0.00	\$0.00	\$0.00	\$0.00	\$0.00	\$0.00	\$0.00	\$12,193.89
City Facilities Account	\$1.73	\$0.00	\$0.00	\$0.00	\$0.00	\$0.00	\$0.00	\$0.00	\$0.00	\$0.00	\$0.00	\$0.00	\$1.73
Interest Account	\$0.00	\$0.00	\$0.00	\$0.00	\$0.00	\$0.00	\$0.00	\$0.00	\$0.00	\$0.00	\$0.00	\$0.00	\$0.00
Letter of Credit Fund	\$0.00	\$0.00	\$0.00	\$0.00	\$0.00	\$0.00	\$0.00	\$0.00	\$0.00	\$0.00	\$0.00	\$0.00	\$0.00
LOC WL Home/Bay Laing 3C	\$129,001.87	\$0.00	\$1.10	\$0.00	\$1.10	\$0.00	\$0.00	\$0.00	\$0.00	\$0.00	\$0.00	\$0.00	\$129,002.97
Principal Account	\$0.00	\$0.00	\$0.00	\$0.00	\$0.00	\$0.00	\$0.00	\$0.00	\$0.00	\$0.00	\$0.00	\$0.00	\$0.00
Reserve Fund	\$4,846,883.27	\$0.00	\$41.17	\$0.00	\$41.17	\$0.00	\$0.00	\$0.00	\$0.00	\$0.00	\$0.00	\$0.00	\$4,846,924.44
Shea Cash Deposit 5A	\$157,000.88	\$0.00	\$1.33	\$0.00	\$1.33	\$0.00	\$0.00	\$0.00	\$0.00	\$0.00	\$0.00	\$0.00	\$157,002.21
Shea Cash Deposit 9C	\$0.00	\$0.00	\$0.00	\$0.00	\$0.00	\$0.00	\$0.00	\$0.00	\$0.00	\$0.00	\$0.00	\$0.00	\$0.00
Special Tax Fund	\$951,922.73	\$813,536.67	\$5.78	\$0.00	\$813,542.45	\$0.00	\$0.00	\$0.00	\$0.00	\$0.00	\$0.00	(\$57,434.28)	\$1,708,030.90
<b>Total:</b>	\$6,202,835.17	\$813,536.67	\$50.38	\$0.00	\$813,587.05	\$0.00	\$0.00	\$0.00	(\$6,250.00)	\$0.00	(\$6,250.00)	\$0.00	\$7,010,172.22

\$57,434.28 in Special Taxes was transferred from the Special Tax Fund to Administrative Expense Fund to meet the annual administrative expense requirement pursuant to the Bond Indenture.

## SOURCES AND USES OF FUNDS

02/01/2013

Account Name	SOURCES				USES							Ending Balance	
	Beginning Balance	Special Tax Receipts	Investment Earnings	Miscellaneous	Total Sources	Interest Payments	Principal Payments	Acquisition/Construction Payments	Legal/Consulting/Services	Miscellaneous	Total Uses		Transfer
Administration Expense Fund	\$157,016.08	\$0.00	\$1.19	\$0.00	\$1.19	\$0.00	\$0.00	\$0.00	\$0.00	\$0.00	\$0.00	\$0.00	\$157,017.27
CalTrans Improvement Account	\$12,193.89	\$0.00	\$0.10	\$0.00	\$0.10	\$0.00	\$0.00	\$0.00	\$0.00	\$0.00	\$0.00	\$0.00	\$12,193.99
City Facilities Account	\$1.73	\$0.00	\$0.00	\$0.00	\$0.00	\$0.00	\$0.00	\$0.00	\$0.00	\$0.00	\$0.00	\$0.00	\$1.73
Interest Account	\$0.00	\$0.00	\$0.00	\$0.00	\$0.00	\$0.00	\$0.00	\$0.00	\$0.00	\$0.00	\$0.00	\$0.00	\$0.00
Letter of Credit Fund	\$0.00	\$0.00	\$0.00	\$0.00	\$0.00	\$0.00	\$0.00	\$0.00	\$0.00	\$0.00	\$0.00	\$0.00	\$0.00
LOC WL Home/Bay Laing 3C	\$129,002.97	\$0.00	\$1.10	\$0.00	\$1.10	\$0.00	\$0.00	\$0.00	\$0.00	\$0.00	\$0.00	\$0.00	\$129,004.07
Principal Account	\$0.00	\$0.00	\$0.00	\$0.00	\$0.00	\$0.00	\$0.00	\$0.00	\$0.00	\$0.00	\$0.00	\$0.00	\$0.00
Reserve Fund	\$4,846,924.44	\$0.00	\$41.17	\$0.00	\$41.17	\$0.00	\$0.00	\$0.00	\$0.00	\$0.00	\$0.00	\$0.00	\$4,846,965.61
Shea Cash Deposit 5A	\$157,002.21	\$0.00	\$1.33	\$0.00	\$1.33	\$0.00	\$0.00	\$0.00	\$0.00	\$0.00	\$0.00	\$0.00	\$157,003.54
Shea Cash Deposit 9C	\$0.00	\$0.00	\$0.00	\$0.00	\$0.00	\$0.00	\$0.00	\$0.00	\$0.00	\$0.00	\$0.00	\$0.00	\$0.00
Special Tax Fund	\$1,708,030.90	\$50,082.34	\$11.32	\$0.00	\$50,093.66	\$0.00	\$0.00	\$0.00	\$0.00	\$0.00	\$0.00	\$0.00	\$1,758,124.56
<b>Total:</b>	<b>\$7,010,172.22</b>	<b>\$50,082.34</b>	<b>\$56.21</b>	<b>\$0.00</b>	<b>\$50,138.55</b>	<b>\$0.00</b>	<b>\$0.00</b>	<b>\$0.00</b>	<b>\$0.00</b>	<b>\$0.00</b>	<b>\$0.00</b>	<b>\$0.00</b>	<b>\$7,060,310.77</b>

## SOURCES AND USES OF FUNDS

03/01/2013

Account Name	SOURCES				USES							Ending Balance	
	Beginning Balance	Special Tax Receipts	Investment Earnings	Miscellaneous	Total Sources	Interest Payments	Principal Payments	Acquisition/ Construction Payments	Legal/ Consulting/ Services	Miscellaneous	Total Uses		Transfer
Administration Expense Fund	\$157,017.27	\$0.00	\$1.20	\$0.00	\$1.20	\$0.00	\$0.00	\$0.00	\$0.00	\$0.00	\$0.00	\$0.00	\$157,018.47
CalTrans Improvement Account	\$12,193.99	\$0.00	\$0.09	\$0.00	\$0.09	\$0.00	\$0.00	\$0.00	\$0.00	\$0.00	\$0.00	\$0.00	\$12,194.08
City Facilities Account	\$1.73	\$0.00	\$0.00	\$0.00	\$0.00	\$0.00	\$0.00	\$0.00	\$0.00	\$0.00	\$0.00	\$0.00	\$1.73
Interest Account	\$0.00	\$0.00	\$0.00	\$0.00	\$0.00	(\$1,298,247.50)	\$0.00	\$0.00	\$0.00	\$0.00	(\$1,298,247.50)	\$1,298,487.80	\$240.30
Letter of Credit Fund	\$0.00	\$0.00	\$0.00	\$0.00	\$0.00	\$0.00	\$0.00	\$0.00	\$0.00	\$0.00	\$0.00	\$0.00	\$0.00
LOC WL Home/Bay Laing 3C	\$129,004.07	\$0.00	\$0.99	\$0.00	\$0.99	\$0.00	\$0.00	\$0.00	\$0.00	\$0.00	\$0.00	\$0.00	\$129,005.06
Principal Account	\$0.00	\$0.00	\$0.00	\$0.00	\$0.00	\$0.00	\$0.00	\$0.00	\$0.00	\$0.00	\$0.00	\$0.00	\$0.00
Reserve Fund	\$4,846,965.61	\$0.00	\$37.19	\$0.00	\$37.19	\$0.00	\$0.00	\$0.00	\$0.00	\$0.00	\$0.00	(\$240.30)	\$4,846,762.50
Shea Cash Deposit 5A	\$157,003.54	\$0.00	\$1.20	\$0.00	\$1.20	\$0.00	\$0.00	\$0.00	\$0.00	\$0.00	\$0.00	\$0.00	\$157,004.74
Shea Cash Deposit 9C	\$0.00	\$0.00	\$0.00	\$0.00	\$0.00	\$0.00	\$0.00	\$0.00	\$0.00	\$0.00	\$0.00	\$0.00	\$0.00
Special Tax Fund	\$1,758,124.56	\$121,823.20	\$13.31	\$0.00	\$121,836.51	\$0.00	\$0.00	\$0.00	\$0.00	\$0.00	\$0.00	(\$1,298,247.50)	\$581,713.57
<b>Total:</b>	<b>\$7,060,310.77</b>	<b>\$121,823.20</b>	<b>\$53.98</b>	<b>\$0.00</b>	<b>\$121,877.18</b>	<b>(\$1,298,247.50)</b>	<b>\$0.00</b>	<b>\$0.00</b>	<b>\$0.00</b>	<b>\$0.00</b>	<b>(\$1,298,247.50)</b>	<b>\$0.00</b>	<b>\$5,883,940.45</b>

\$240.30 in Reserve Fund excess was transferred from the Reserve Fund to the Interest Account for the March debt service obligation pursuant to the Bond Indenture.

\$1,298,247.50 was paid in Interest from the Interest Account for the March debt service obligation.

## SOURCES AND USES OF FUNDS

04/01/2013

Account Name	SOURCES				USES							Ending Balance	
	Beginning Balance	Special Tax Receipts	Investment Earnings	Miscellaneous	Total Sources	Interest Payments	Principal Payments	Acquisition/ Construction Payments	Legal/ Consulting/ Services	Miscellaneous	Total Uses		Transfer
Administration Expense Fund	\$157,018.47	\$0.00	\$1.33	\$0.00	\$1.33	\$0.00	\$0.00	\$0.00	(\$6,250.00)	\$0.00	(\$6,250.00)	\$0.00	\$150,769.80
CalTrans Improvement Account	\$12,194.08	\$0.00	\$0.10	\$0.00	\$0.10	\$0.00	\$0.00	\$0.00	\$0.00	\$0.00	\$0.00	\$0.00	\$12,194.18
City Facilities Account	\$1.73	\$0.00	\$0.00	\$0.00	\$0.00	\$0.00	\$0.00	\$0.00	\$0.00	\$0.00	\$0.00	\$0.00	\$1.73
Interest Account	\$240.30	\$0.00	\$0.00	\$0.00	\$0.00	\$0.00	\$0.00	\$0.00	\$0.00	\$0.00	\$0.00	\$0.00	\$240.30
Letter of Credit Fund	\$0.00	\$0.00	\$0.00	\$0.00	\$0.00	\$0.00	\$0.00	\$0.00	\$0.00	\$0.00	\$0.00	\$0.00	\$0.00
LOC WL Home/Bay Laing 3C	\$129,005.06	\$0.00	\$1.10	\$0.00	\$1.10	\$0.00	\$0.00	\$0.00	\$0.00	\$0.00	\$0.00	\$0.00	\$129,006.16
Principal Account	\$0.00	\$0.00	\$0.00	\$0.00	\$0.00	\$0.00	\$0.00	\$0.00	\$0.00	\$0.00	\$0.00	\$0.00	\$0.00
Reserve Fund	\$4,846,762.50	\$0.00	\$41.17	\$0.00	\$41.17	\$0.00	\$0.00	\$0.00	\$0.00	\$0.00	\$0.00	\$0.00	\$4,846,803.67
Shea Cash Deposit 5A	\$157,004.74	\$0.00	\$1.33	\$0.00	\$1.33	\$0.00	\$0.00	\$0.00	\$0.00	\$0.00	\$0.00	\$0.00	\$157,006.07
Shea Cash Deposit 9C	\$0.00	\$0.00	\$0.00	\$0.00	\$0.00	\$0.00	\$0.00	\$0.00	\$0.00	\$0.00	\$0.00	\$0.00	\$0.00
Special Tax Fund	\$581,713.57	\$437,331.15	\$4.54	\$0.00	\$437,335.69	\$0.00	\$0.00	\$0.00	\$0.00	\$0.00	\$0.00	\$0.00	\$1,019,049.26
<b>Total:</b>	<b>\$5,883,940.45</b>	<b>\$437,331.15</b>	<b>\$49.57</b>	<b>\$0.00</b>	<b>\$437,380.72</b>	<b>\$0.00</b>	<b>\$0.00</b>	<b>\$0.00</b>	<b>(\$6,250.00)</b>	<b>\$0.00</b>	<b>(\$6,250.00)</b>	<b>\$0.00</b>	<b>\$6,315,071.17</b>

**Exhibit C**

**Annual Special Tax Roll  
Fiscal Year 2013/2014**

**Poway Unified School District  
Improvement Area A of CFD No. 14  
Special Tax Levy For Fiscal Year 2013/2014**

<b>Book</b>	<b>Page</b>	<b>Parcel</b>	<b>Interest</b>	<b>Special Tax</b>
267	241	1	0	\$3,034.26
267	241	2	0	\$2,345.66
267	241	3	0	\$2,612.22
267	241	4	0	\$3,034.26
267	241	5	0	\$2,345.66
267	241	6	0	\$2,612.22
267	241	7	0	\$3,034.26
267	241	8	0	\$2,612.22
267	241	9	0	\$2,345.66
267	241	10	0	\$3,034.26
267	241	11	0	\$2,612.22
267	241	12	0	\$3,056.48
267	241	13	0	\$2,612.22
267	241	14	0	\$2,345.66
267	241	15	0	\$3,034.26
267	241	16	0	\$2,612.22
267	241	17	0	\$2,345.66
267	241	18	0	\$2,945.40
267	241	19	0	\$2,612.22
267	241	20	0	\$2,345.66
267	241	21	0	\$3,034.26
267	241	22	0	\$2,345.66
267	241	23	0	\$2,612.22
267	241	24	0	\$3,034.26
267	241	25	0	\$2,345.66
267	281	1	0	\$2,612.22
267	281	2	0	\$3,034.26
267	281	3	0	\$2,345.66
267	281	4	0	\$3,056.48
267	281	5	0	\$2,612.22
267	281	6	0	\$2,945.40
267	281	7	0	\$2,612.22
267	281	8	0	\$3,056.48
267	281	9	0	\$2,612.22
267	281	10	0	\$2,345.66
267	281	11	0	\$2,612.22
267	281	12	0	\$3,056.48
267	281	13	0	\$2,612.22
267	281	14	0	\$2,345.66
267	241	26	0	\$3,034.26
267	241	27	0	\$2,612.22
267	241	28	0	\$2,345.66
267	241	29	0	\$3,034.26
267	241	30	0	\$2,612.22

**Poway Unified School District  
Improvement Area A of CFD No. 14  
Special Tax Levy For Fiscal Year 2013/2014**

<b>Book</b>	<b>Page</b>	<b>Parcel</b>	<b>Interest</b>	<b>Special Tax</b>
267	241	31	0	\$2,945.40
267	241	32	0	\$2,945.40
267	241	33	0	\$2,612.22
267	241	34	0	\$2,612.22
267	241	35	0	\$2,345.66
267	241	36	0	\$3,034.26
267	241	37	0	\$2,612.22
267	281	15	0	\$2,345.66
267	281	16	0	\$3,034.26
267	281	17	0	\$2,945.40
267	281	18	0	\$2,612.22
267	241	38	0	\$3,034.26
267	241	39	0	\$2,345.66
267	241	40	0	\$2,612.22
267	241	41	0	\$3,034.26
267	281	19	0	\$2,612.22
267	281	20	0	\$3,056.48
267	281	21	0	\$2,345.66
267	281	22	0	\$2,612.22
267	281	23	0	\$2,345.66
267	281	24	0	\$3,034.26
267	281	25	0	\$2,945.40
267	281	26	0	\$2,612.22
267	281	27	0	\$2,345.66
267	281	28	0	\$3,034.26
267	281	29	0	\$2,612.22
267	281	30	0	\$3,034.26
267	281	31	0	\$2,345.66
267	281	32	0	\$2,612.22
267	281	33	0	\$3,034.26
267	281	34	0	\$2,945.40
267	281	35	0	\$2,612.22
267	281	36	0	\$2,612.22
267	281	37	0	\$2,345.66
267	281	38	0	\$0.00
267	241	42	0	\$0.00
267	241	43	0	\$0.00
267	241	44	0	\$0.00
267	281	39	0	\$0.00
267	281	40	0	\$0.00
267	280	1	0	\$3,056.48
267	280	2	0	\$3,056.48
267	280	3	0	\$3,056.48
267	280	4	0	\$3,056.48



**Poway Unified School District  
Improvement Area A of CFD No. 14  
Special Tax Levy For Fiscal Year 2013/2014**

<b>Book</b>	<b>Page</b>	<b>Parcel</b>	<b>Interest</b>	<b>Special Tax</b>
267	280	5	0	\$3,056.48
267	280	6	0	\$3,167.54
267	280	7	0	\$3,056.48
267	280	8	0	\$3,056.48
267	280	9	0	\$3,056.48
267	280	10	0	\$3,056.48
267	280	11	0	\$3,056.48
267	280	12	0	\$3,056.48
267	280	13	0	\$3,167.54
267	280	14	0	\$3,056.48
267	280	15	0	\$3,056.48
267	280	16	0	\$3,056.48
267	280	17	0	\$3,056.48
267	280	18	0	\$3,056.48
267	280	19	0	\$3,167.54
267	280	20	0	\$3,056.48
267	280	21	0	\$3,056.48
267	280	22	0	\$3,056.48
267	280	23	0	\$3,167.54
267	280	24	0	\$3,056.48
267	280	25	0	\$3,056.48
267	280	26	0	\$3,056.48
267	280	27	0	\$3,056.48
267	280	28	0	\$3,056.48
267	280	29	0	\$3,056.48
267	280	30	0	\$3,056.48
267	280	31	0	\$3,056.48
267	280	32	0	\$0.00
267	240	1	0	\$3,367.44
267	240	2	0	\$3,741.50
267	240	3	0	\$3,367.44
267	240	4	0	\$3,741.50
267	240	5	0	\$3,367.44
267	240	6	0	\$3,741.50
267	240	7	0	\$3,367.44
267	240	8	0	\$3,367.44
267	240	9	0	\$3,741.50
267	240	10	0	\$3,741.50
267	240	11	0	\$3,367.44
267	240	12	0	\$3,741.50
267	240	13	0	\$3,367.44
267	240	14	0	\$3,741.50
267	240	15	0	\$3,367.44
267	240	16	0	\$3,741.50

**Poway Unified School District  
Improvement Area A of CFD No. 14  
Special Tax Levy For Fiscal Year 2013/2014**

<b>Book</b>	<b>Page</b>	<b>Parcel</b>	<b>Interest</b>	<b>Special Tax</b>
267	240	17	0	\$3,367.44
267	240	18	0	\$3,367.44
267	240	19	0	\$3,367.44
267	240	20	0	\$3,741.50
267	240	21	0	\$3,367.44
267	240	22	0	\$3,741.50
267	240	23	0	\$3,367.44
267	240	24	0	\$3,741.50
267	240	25	0	\$3,367.44
267	240	26	0	\$3,741.50
267	240	27	0	\$3,367.44
267	240	28	0	\$3,741.50
267	240	29	0	\$3,367.44
267	240	30	0	\$3,741.50
267	240	31	0	\$3,367.44
267	240	32	0	\$3,741.50
267	240	33	0	\$3,367.44
267	240	34	0	\$3,741.50
267	240	35	0	\$3,167.54
267	240	36	0	\$3,741.50
267	240	37	0	\$3,367.44
267	240	38	0	\$3,741.50
267	240	39	0	\$3,367.44
267	240	40	0	\$3,741.50
267	240	41	0	\$3,367.44
267	240	42	0	\$0.00
267	240	43	0	\$0.00
267	240	44	0	\$0.00
267	320	1	0	\$3,167.54
267	320	2	0	\$3,056.48
267	320	3	0	\$3,741.50
267	320	4	0	\$3,167.54
267	320	5	0	\$3,367.44
267	320	6	0	\$3,056.48
267	320	7	0	\$3,167.54
267	320	8	0	\$3,056.48
267	320	9	0	\$3,741.50
267	320	10	1	\$2,445.62
267	320	10	2	\$2,709.96
267	320	11	1	\$2,709.96
267	320	11	2	\$2,709.96
267	320	12	1	\$2,445.62
267	320	12	2	\$2,709.96
267	320	13	1	\$2,709.96

**Poway Unified School District  
Improvement Area A of CFD No. 14  
Special Tax Levy For Fiscal Year 2013/2014**

<b>Book</b>	<b>Page</b>	<b>Parcel</b>	<b>Interest</b>	<b>Special Tax</b>
267	320	13	2	\$2,709.96
267	320	14	1	\$2,709.96
267	320	14	2	\$2,709.96
267	320	15	1	\$2,709.96
267	320	15	2	\$2,445.62
267	321	16	1	\$2,709.96
267	321	16	2	\$2,709.96
267	321	16	3	\$2,709.96
267	321	16	4	\$2,709.96
267	321	16	5	\$2,709.96
267	321	16	6	\$2,709.96
267	321	16	9	\$2,709.96
267	321	16	10	\$2,709.96
267	321	16	11	\$2,709.96
267	321	16	12	\$2,445.62
267	321	16	7	\$2,709.96
267	321	16	8	\$2,709.96
267	321	7	0	\$3,741.50
267	321	8	0	\$3,056.48
267	321	9	0	\$3,167.54
267	321	10	0	\$3,741.50
267	321	11	0	\$3,056.48
267	321	12	0	\$3,367.44
267	321	13	0	\$3,167.54
267	321	14	0	\$3,741.50
267	321	15	0	\$0.00
267	320	16	0	\$0.00
267	330	1	0	\$2,612.22
267	330	2	0	\$2,612.22
267	330	3	0	\$2,612.22
267	330	4	0	\$2,612.22
267	330	5	0	\$2,345.66
267	330	6	0	\$2,612.22
267	330	7	0	\$2,345.66
267	330	8	0	\$2,612.22
267	330	9	0	\$2,345.66
267	330	10	0	\$2,612.22
267	330	11	0	\$2,612.22
267	330	12	0	\$2,612.22
267	330	13	0	\$2,345.66
267	330	14	0	\$2,612.22
267	330	15	0	\$2,612.22
267	330	16	0	\$2,612.22
267	330	17	0	\$2,345.66

**Poway Unified School District  
Improvement Area A of CFD No. 14  
Special Tax Levy For Fiscal Year 2013/2014**

<b>Book</b>	<b>Page</b>	<b>Parcel</b>	<b>Interest</b>	<b>Special Tax</b>
267	330	18	0	\$2,612.22
267	330	19	0	\$2,612.22
267	330	20	0	\$2,345.66
267	330	21	0	\$2,612.22
267	330	22	0	\$2,612.22
267	330	23	0	\$2,345.66
267	330	24	0	\$2,345.66
267	330	25	0	\$2,612.22
267	330	26	0	\$2,345.66
267	330	27	0	\$2,612.22
267	330	28	0	\$2,612.22
267	330	29	0	\$2,345.66
267	330	30	0	\$2,612.22
267	330	31	0	\$2,612.22
267	330	32	0	\$2,612.22
267	330	33	0	\$2,612.22
267	330	34	0	\$2,345.66
267	330	35	0	\$2,612.22
267	330	36	0	\$2,612.22
267	330	37	0	\$2,345.66
267	330	38	0	\$2,612.22
267	330	39	0	\$2,345.66
267	330	40	0	\$2,612.22
267	330	41	0	\$2,612.22
267	330	42	0	\$2,345.66
267	330	43	0	\$2,612.22
267	330	44	0	\$2,612.22
267	330	45	0	\$2,345.66
267	330	46	0	\$2,612.22
267	330	47	0	\$2,345.66
267	330	48	0	\$2,612.22
267	330	49	0	\$2,345.66
267	330	50	0	\$2,612.22
267	330	51	0	\$2,612.22
267	330	52	0	\$2,345.66
267	330	53	0	\$2,612.22
267	330	54	0	\$2,612.22
267	330	55	0	\$2,612.22
267	330	56	0	\$2,345.66
267	330	57	0	\$2,612.22
267	330	58	0	\$2,612.22
267	330	59	0	\$2,612.22
267	330	60	0	\$2,345.66
267	330	61	0	\$2,612.22

**Poway Unified School District  
Improvement Area A of CFD No. 14  
Special Tax Levy For Fiscal Year 2013/2014**

<b>Book</b>	<b>Page</b>	<b>Parcel</b>	<b>Interest</b>	<b>Special Tax</b>
267	330	62	0	\$2,612.22
267	330	63	0	\$2,345.66
267	330	64	0	\$2,612.22
267	330	65	0	\$2,612.22
267	330	66	0	\$2,345.66
267	330	67	0	\$2,612.22
267	330	68	0	\$2,612.22
267	330	69	0	\$2,612.22
267	330	70	0	\$0.00
267	330	71	0	\$0.00
267	330	72	0	\$0.00
267	330	73	0	\$0.00
267	330	74	0	\$0.00
267	330	75	0	\$0.00
267	330	80	0	\$0.00
267	330	76	0	\$0.00
267	330	77	0	\$0.00
267	330	78	0	\$0.00
267	330	79	0	\$0.00
267	250	1	0	\$3,741.50
267	250	2	0	\$3,367.44
267	250	3	0	\$3,741.50
267	250	4	0	\$3,367.44
267	250	5	0	\$3,741.50
267	250	6	0	\$3,367.44
267	250	7	0	\$3,741.50
267	250	8	0	\$3,367.44
267	250	9	0	\$3,367.44
267	250	10	0	\$3,741.50
267	250	11	0	\$3,167.54
267	250	12	0	\$3,741.50
267	250	13	0	\$3,367.44
267	250	14	0	\$3,741.50
267	250	15	0	\$3,367.44
267	250	16	0	\$3,741.50
267	250	17	0	\$3,367.44
267	250	18	0	\$3,741.50
267	250	19	0	\$3,367.44
267	250	20	0	\$3,367.44
267	250	21	0	\$3,741.50
267	250	22	0	\$3,367.44
267	250	23	0	\$3,741.50
267	250	24	0	\$3,167.54
267	250	25	0	\$3,741.50

**Poway Unified School District  
Improvement Area A of CFD No. 14  
Special Tax Levy For Fiscal Year 2013/2014**

<b>Book</b>	<b>Page</b>	<b>Parcel</b>	<b>Interest</b>	<b>Special Tax</b>
267	250	26	0	\$3,367.44
267	250	27	0	\$3,741.50
267	250	28	0	\$3,367.44
267	250	29	0	\$3,741.50
267	250	30	0	\$0.00
267	231	1	0	\$3,056.48
267	231	2	0	\$3,167.54
267	231	3	0	\$3,741.50
267	231	4	0	\$3,167.54
267	231	5	0	\$3,367.44
267	231	6	0	\$3,056.48
267	231	7	0	\$3,167.54
267	231	8	0	\$3,367.44
267	231	9	0	\$3,056.48
267	231	10	1	\$2,709.96
267	231	10	2	\$2,709.96
267	231	11	1	\$2,445.62
267	231	11	2	\$2,709.96
267	231	12	1	\$2,709.96
267	231	12	2	\$2,709.96
267	231	13	1	\$2,709.96
267	231	13	2	\$2,709.96
267	231	14	1	\$2,709.96
267	231	14	2	\$2,709.96
267	231	15	1	\$2,709.96
267	231	15	2	\$2,709.96
267	231	16	1	\$2,709.96
267	231	16	2	\$2,709.96
267	231	17	0	\$0.00
267	290	1	0	\$3,056.48
267	290	2	0	\$3,056.48
267	290	3	0	\$3,056.48
267	290	4	0	\$3,056.48
267	290	5	0	\$3,056.48
267	290	6	0	\$3,056.48
267	290	7	0	\$3,056.48
267	290	8	0	\$3,167.54
267	290	9	0	\$3,056.48
267	290	10	0	\$3,056.48
267	290	11	0	\$3,056.48
267	290	12	0	\$3,056.48
267	290	13	0	\$3,167.54
267	290	14	0	\$3,056.48
267	290	15	0	\$3,056.48

**Poway Unified School District  
Improvement Area A of CFD No. 14  
Special Tax Levy For Fiscal Year 2013/2014**

<b>Book</b>	<b>Page</b>	<b>Parcel</b>	<b>Interest</b>	<b>Special Tax</b>
267	290	16	0	\$3,056.48
267	290	17	0	\$3,056.48
267	290	18	0	\$3,056.48
267	290	19	0	\$3,056.48
267	290	20	0	\$3,167.54
267	290	21	0	\$3,056.48
267	290	22	0	\$3,056.48
267	290	23	0	\$3,056.48
267	290	24	0	\$3,056.48
267	290	25	0	\$3,056.48
267	290	26	0	\$3,167.54
267	290	27	0	\$3,056.48
267	290	28	0	\$3,056.48
267	290	29	0	\$3,167.54
267	290	30	0	\$3,056.48
267	290	31	0	\$3,056.48
267	290	32	0	\$3,056.48
267	290	33	0	\$3,056.48
267	290	34	0	\$3,056.48
267	290	35	0	\$3,167.54
267	290	36	0	\$3,056.48
267	290	37	0	\$3,056.48
267	290	38	0	\$3,167.54
267	290	39	0	\$3,056.48
267	290	40	0	\$3,056.48
267	290	41	0	\$3,056.48
267	290	42	0	\$3,056.48
267	290	43	0	\$3,056.48
267	290	44	0	\$3,056.48
267	290	45	0	\$3,056.48
267	290	46	0	\$3,056.48
267	290	47	0	\$3,167.54
267	290	48	0	\$3,056.48
267	290	49	0	\$3,056.48
267	290	50	0	\$3,167.54
267	290	51	0	\$3,056.48
267	290	52	0	\$3,056.48
267	290	54	0	\$0.00
267	290	53	0	\$0.00
267	340	1	0	\$3,167.54
267	340	2	0	\$3,367.44
267	340	3	0	\$3,741.50
267	340	4	0	\$3,367.44
267	340	5	0	\$3,167.54

**Poway Unified School District  
Improvement Area A of CFD No. 14  
Special Tax Levy For Fiscal Year 2013/2014**

<b>Book</b>	<b>Page</b>	<b>Parcel</b>	<b>Interest</b>	<b>Special Tax</b>
267	340	6	0	\$3,367.44
267	340	7	0	\$3,167.54
267	340	8	0	\$3,367.44
267	340	9	0	\$3,167.54
267	340	10	0	\$3,367.44
267	340	11	0	\$3,167.54
267	340	12	0	\$3,367.44
267	340	13	0	\$3,167.54
267	340	14	0	\$3,367.44
267	340	15	0	\$3,167.54
267	340	16	0	\$3,367.44
267	340	17	0	\$3,741.50
267	340	18	0	\$3,367.44
267	340	19	0	\$3,367.44
267	340	20	0	\$3,741.50
267	340	21	0	\$3,167.54
267	340	22	0	\$3,367.44
267	340	23	0	\$3,167.54
267	340	24	0	\$3,367.44
267	340	25	0	\$3,741.50
267	340	26	0	\$3,167.54
267	340	27	0	\$3,367.44
267	340	28	0	\$3,741.50
267	340	29	0	\$3,741.50
267	340	30	0	\$3,367.44
267	340	31	0	\$3,167.54
267	340	32	0	\$3,367.44
267	340	33	0	\$3,367.44
267	340	34	0	\$3,167.54
267	340	35	0	\$3,741.50
267	340	36	0	\$3,367.44
267	340	37	0	\$3,741.50
267	340	38	0	\$3,367.44
267	340	39	0	\$3,167.54
267	340	40	0	\$3,367.44
267	340	41	0	\$3,741.50
267	340	42	0	\$3,367.44
267	340	43	0	\$3,741.50
267	340	44	0	\$3,367.44
267	340	45	0	\$3,741.50
267	340	46	0	\$3,367.44
267	340	47	0	\$3,741.50
267	340	48	0	\$3,367.44
267	340	49	0	\$3,167.54



**Poway Unified School District  
Improvement Area A of CFD No. 14  
Special Tax Levy For Fiscal Year 2013/2014**

<b>Book</b>	<b>Page</b>	<b>Parcel</b>	<b>Interest</b>	<b>Special Tax</b>
267	340	50	0	\$3,167.54
267	340	51	0	\$3,741.50
267	340	52	0	\$3,367.44
267	340	53	0	\$3,167.54
267	340	54	0	\$4,260.40
267	340	55	0	\$4,260.40
267	340	56	0	\$4,149.34
267	340	57	0	\$4,260.40
267	340	58	0	\$4,260.40
267	340	59	0	\$3,167.54
267	340	60	0	\$3,367.44
267	340	61	0	\$3,741.50
267	340	62	0	\$3,367.44
267	340	63	0	\$3,741.50
267	340	64	0	\$3,741.50
267	340	65	0	\$3,367.44
267	340	66	0	\$3,167.54
267	340	67	0	\$3,741.50
267	340	68	0	\$3,367.44
267	340	69	0	\$3,741.50
267	340	70	0	\$3,167.54
267	340	71	0	\$0.00
267	340	72	0	\$0.00
267	231	18	0	\$3,056.48
267	231	19	0	\$3,056.48
267	231	20	0	\$2,612.22
267	231	21	0	\$3,056.48
267	231	22	0	\$3,056.48
267	231	23	0	\$2,612.22
267	231	24	0	\$3,034.26
267	231	25	0	\$3,056.48
267	231	26	0	\$2,612.22
267	231	27	0	\$2,945.40
267	231	28	0	\$3,056.48
267	231	29	0	\$2,612.22
267	231	30	0	\$2,945.40
267	231	31	0	\$3,056.48
267	231	32	0	\$2,612.22
267	231	33	0	\$2,945.40
267	231	34	0	\$3,056.48
267	231	35	0	\$2,612.22
267	231	36	0	\$3,034.26
267	231	37	0	\$3,056.48
267	231	38	0	\$2,612.22

**Poway Unified School District  
Improvement Area A of CFD No. 14  
Special Tax Levy For Fiscal Year 2013/2014**

<b>Book</b>	<b>Page</b>	<b>Parcel</b>	<b>Interest</b>	<b>Special Tax</b>
267	231	39	0	\$2,345.66
267	231	40	0	\$2,612.22
267	231	41	0	\$3,034.26
267	231	42	0	\$2,945.40
267	231	43	0	\$2,612.22
267	231	44	0	\$3,034.26
267	231	45	0	\$2,612.22
267	231	46	0	\$3,056.48
267	231	47	0	\$3,056.48
267	231	48	0	\$2,612.22
267	231	49	0	\$2,345.66
267	231	50	0	\$3,056.48
267	231	51	0	\$2,612.22
267	231	52	0	\$3,034.26
267	231	53	0	\$2,345.66
267	231	54	0	\$0.00
267	231	55	0	\$0.00
267	231	56	0	\$0.00
267	232	1	0	\$2,612.22
267	232	2	0	\$2,345.66
267	232	3	0	\$2,612.22
267	232	4	0	\$2,612.22
267	232	5	0	\$2,612.22
267	232	6	0	\$2,345.66
267	232	7	0	\$2,612.22
267	232	8	0	\$2,612.22
267	232	9	0	\$2,345.66
267	232	10	0	\$2,612.22
267	232	11	0	\$2,612.22
267	232	12	0	\$2,345.66
267	232	13	0	\$2,612.22
267	232	14	0	\$2,612.22
267	232	15	0	\$2,612.22
267	232	16	0	\$2,612.22
267	232	17	0	\$2,612.22
267	232	18	0	\$2,345.66
267	232	19	0	\$2,612.22
267	232	20	0	\$2,612.22
267	232	21	0	\$2,345.66
267	232	22	0	\$2,612.22
267	232	23	0	\$2,612.22
267	232	24	0	\$2,612.22
267	232	25	0	\$2,612.22
267	232	26	0	\$2,612.22

**Poway Unified School District  
Improvement Area A of CFD No. 14  
Special Tax Levy For Fiscal Year 2013/2014**

<b>Book</b>	<b>Page</b>	<b>Parcel</b>	<b>Interest</b>	<b>Special Tax</b>
267	232	27	0	\$2,612.22
267	232	28	0	\$2,345.66
267	232	29	0	\$2,612.22
267	232	30	0	\$2,612.22
267	232	31	0	\$2,612.22
267	232	32	0	\$2,345.66
267	232	33	0	\$2,612.22
267	232	34	0	\$2,612.22
267	232	35	0	\$2,345.66
267	232	36	0	\$2,612.22
267	232	37	0	\$2,612.22
267	232	38	0	\$2,345.66
267	232	39	0	\$2,612.22
267	232	40	0	\$2,345.66
267	232	41	0	\$2,612.22
267	232	42	0	\$2,612.22
267	232	43	0	\$2,345.66
267	232	44	0	\$2,612.22
267	232	45	0	\$2,612.22
267	232	46	0	\$2,345.66
267	232	47	0	\$2,612.22
267	232	48	0	\$2,612.22
267	232	49	0	\$2,345.66
267	232	50	0	\$2,612.22
267	232	51	0	\$2,612.22
267	232	52	0	\$2,612.22
267	232	53	0	\$2,345.66
267	232	54	0	\$2,612.22
267	232	55	0	\$2,612.22
267	232	56	0	\$2,612.22
267	232	57	0	\$2,345.66
267	232	58	0	\$2,612.22
267	232	59	0	\$2,612.22
267	232	60	0	\$2,612.22
267	232	61	0	\$2,612.22
267	232	62	0	\$2,345.66
267	232	63	0	\$2,612.22
267	232	64	0	\$2,612.22
267	232	65	0	\$2,345.66
267	232	66	0	\$2,612.22
267	232	67	0	\$2,612.22
267	232	68	0	\$2,345.66
267	232	69	0	\$2,612.22
267	232	70	0	\$2,612.22

**Poway Unified School District  
Improvement Area A of CFD No. 14  
Special Tax Levy For Fiscal Year 2013/2014**

<b>Book</b>	<b>Page</b>	<b>Parcel</b>	<b>Interest</b>	<b>Special Tax</b>
267	232	71	0	\$2,612.22
267	232	72	0	\$2,345.66
267	232	73	0	\$2,612.22
267	232	74	0	\$2,612.22
267	232	75	0	\$2,345.66
267	232	76	0	\$2,612.22
267	232	77	0	\$2,612.22
267	232	78	0	\$2,345.66
267	232	79	0	\$2,612.22
267	232	80	0	\$2,612.22
267	232	81	0	\$2,345.66
267	232	82	0	\$2,612.22
267	232	83	0	\$2,612.22
267	232	84	0	\$2,345.66
267	232	85	0	\$0.00
267	232	86	0	\$0.00
267	232	87	0	\$0.00
267	232	88	0	\$0.00
267	232	89	0	\$0.00
267	232	90	0	\$0.00
267	232	91	0	\$0.00
267	350	1	0	\$3,741.50
267	350	2	0	\$3,167.54
267	350	3	0	\$3,741.50
267	350	4	0	\$3,167.54
267	350	5	0	\$3,056.48
267	350	6	0	\$3,741.50
267	350	7	0	\$3,167.54
267	350	8	0	\$3,367.44
267	350	9	0	\$3,741.50
267	350	10	0	\$3,167.54
267	350	11	0	\$3,367.44
267	350	12	0	\$3,167.54
267	350	13	0	\$3,741.50
267	350	14	0	\$3,056.48
267	350	15	0	\$3,167.54
267	350	16	0	\$3,741.50
267	350	17	0	\$3,167.54
267	350	18	0	\$3,741.50
267	350	29	1	\$2,709.96
267	350	29	2	\$2,445.62
267	350	30	1	\$2,709.96
267	350	30	2	\$2,709.96
267	350	31	1	\$2,709.96

**Poway Unified School District  
Improvement Area A of CFD No. 14  
Special Tax Levy For Fiscal Year 2013/2014**

<b>Book</b>	<b>Page</b>	<b>Parcel</b>	<b>Interest</b>	<b>Special Tax</b>
267	350	31	2	\$2,445.62
267	350	32	1	\$2,709.96
267	350	32	2	\$2,709.96
267	350	33	1	\$2,709.96
267	350	33	2	\$2,709.96
267	350	34	1	\$2,709.96
267	350	34	2	\$2,709.96
267	350	35	1	\$2,709.96
267	350	35	2	\$2,445.62
267	350	36	1	\$2,709.96
267	350	36	2	\$2,445.62
267	350	37	1	\$2,709.96
267	350	37	2	\$2,709.96
267	350	38	1	\$2,709.96
267	350	38	2	\$2,709.96
267	350	39	0	\$3,056.48
267	350	40	0	\$3,741.50
267	350	41	0	\$3,167.54
267	350	42	0	\$3,167.54
267	350	43	0	\$3,056.48
267	350	44	0	\$3,167.54
267	350	45	0	\$3,056.48
267	350	46	0	\$3,367.44
267	350	47	0	\$3,167.54
267	350	48	0	\$3,741.50
267	350	49	0	\$3,056.48
267	350	50	0	\$3,167.54
267	350	51	1	\$2,709.96
267	350	51	2	\$2,445.62
267	350	52	0	\$3,167.54
267	350	53	0	\$3,367.44
267	350	54	0	\$3,056.48
267	350	55	0	\$3,741.50
267	350	56	0	\$3,167.54
267	350	57	0	\$3,741.50
267	350	58	0	\$0.00
267	350	59	0	\$0.00
267	350	60	0	\$0.00
267	350	61	0	\$0.00
267	350	62	0	\$0.00
267	341	1	0	\$2,945.40
267	341	2	0	\$3,056.48
267	341	3	0	\$2,612.22
267	341	4	0	\$2,345.66

**Poway Unified School District  
Improvement Area A of CFD No. 14  
Special Tax Levy For Fiscal Year 2013/2014**

<b>Book</b>	<b>Page</b>	<b>Parcel</b>	<b>Interest</b>	<b>Special Tax</b>
267	341	5	0	\$3,034.26
267	341	6	0	\$2,345.66
267	341	7	0	\$3,034.26
267	341	8	0	\$2,612.22
267	341	9	0	\$2,345.66
267	341	10	0	\$3,034.26
267	341	11	0	\$2,945.40
267	341	12	0	\$2,345.66
267	341	13	0	\$2,612.22
267	341	14	0	\$3,056.48
267	341	15	0	\$2,345.66
267	341	16	0	\$2,612.22
267	341	17	0	\$3,034.26
267	341	18	0	\$2,345.66
267	341	19	0	\$2,612.22
267	341	20	0	\$2,345.66
267	341	21	0	\$2,612.22
267	341	22	0	\$3,034.26
267	341	23	0	\$0.00
267	360	1	0	\$2,945.40
267	360	2	0	\$2,945.40
267	360	3	0	\$3,034.26
267	360	4	0	\$2,945.40
267	360	5	0	\$2,945.40
267	360	6	0	\$3,034.26
267	360	7	0	\$2,945.40
267	360	8	0	\$2,945.40
267	360	9	0	\$2,945.40
267	360	10	0	\$3,034.26
267	360	11	0	\$2,945.40
267	360	12	0	\$3,034.26
267	360	13	0	\$2,945.40
267	360	14	0	\$2,945.40
267	360	15	0	\$2,945.40
267	360	16	0	\$2,945.40
267	360	17	0	\$2,945.40
267	360	18	0	\$3,034.26
267	360	19	0	\$2,945.40
267	360	20	0	\$2,945.40
267	360	21	0	\$2,945.40
267	360	22	0	\$2,945.40
267	360	23	0	\$3,034.26
267	360	24	0	\$2,945.40
267	360	25	0	\$3,034.26

**Poway Unified School District  
Improvement Area A of CFD No. 14  
Special Tax Levy For Fiscal Year 2013/2014**

<b>Book</b>	<b>Page</b>	<b>Parcel</b>	<b>Interest</b>	<b>Special Tax</b>
267	360	26	0	\$2,945.40
267	360	27	0	\$2,945.40
267	360	28	0	\$3,034.26
267	360	29	0	\$2,945.40
267	360	30	0	\$2,945.40
267	360	31	0	\$2,945.40
267	360	32	0	\$2,945.40
267	360	33	0	\$3,034.26
267	360	34	0	\$2,945.40
267	360	35	0	\$2,945.40
267	360	36	0	\$3,034.26
267	360	37	0	\$2,945.40
267	360	38	0	\$3,034.26
267	360	39	0	\$2,945.40
267	360	40	0	\$3,034.26
267	360	41	0	\$2,945.40
267	360	42	0	\$3,034.26
267	360	43	0	\$2,945.40
267	360	44	0	\$2,945.40
267	360	45	0	\$3,034.26
267	360	46	0	\$2,945.40
267	360	47	0	\$3,034.26
267	360	48	0	\$2,945.40
267	360	49	0	\$3,034.26
267	360	50	0	\$2,945.40
267	360	51	0	\$3,034.26
267	360	52	0	\$2,945.40
267	360	53	0	\$2,945.40
267	360	54	0	\$2,945.40
267	360	55	0	\$3,034.26
267	360	56	0	\$2,945.40
267	360	57	0	\$3,034.26
267	360	58	0	\$2,945.40
267	360	59	0	\$2,945.40
267	360	60	0	\$3,034.26
267	360	61	0	\$4,260.40
267	360	62	0	\$4,260.40
267	360	63	0	\$4,260.40
267	360	64	0	\$4,260.40
267	360	65	0	\$4,260.40
267	360	66	0	\$4,260.40
267	360	67	0	\$4,260.40
267	360	68	0	\$4,260.40
267	360	69	0	\$4,260.40

**Poway Unified School District  
Improvement Area A of CFD No. 14  
Special Tax Levy For Fiscal Year 2013/2014**

<b>Book</b>	<b>Page</b>	<b>Parcel</b>	<b>Interest</b>	<b>Special Tax</b>
267	360	70	0	\$4,260.40
267	360	71	0	\$4,260.40
267	360	72	0	\$4,260.40
267	360	73	0	\$4,260.40
267	361	1	0	\$0.00
267	361	2	0	\$0.00
267	361	3	0	\$0.00
267	361	4	0	\$0.00
267	361	5	0	\$0.00
267	361	6	0	\$3,741.50
267	361	7	0	\$3,167.54
267	361	8	0	\$3,741.50
267	361	9	0	\$3,741.50
267	361	10	0	\$3,741.50
267	361	11	0	\$3,167.54
267	361	12	0	\$3,741.50
267	361	13	0	\$3,741.50
267	361	14	0	\$0.00
267	361	15	0	\$0.00
267	361	16	0	\$0.00
267	361	17	0	\$4,149.34
267	361	18	0	\$3,367.44
267	361	19	0	\$3,741.50
267	361	20	0	\$4,149.34
267	361	21	0	\$3,741.50
267	361	22	0	\$4,149.34
267	361	23	0	\$3,367.44
267	361	24	0	\$0.00
267	361	25	0	\$0.00
267	361	26	0	\$0.00
267	361	27	0	\$0.00
267	361	28	0	\$0.00
267	361	29	0	\$3,367.44
267	361	30	0	\$3,741.50
267	361	31	0	\$4,149.34
267	361	32	0	\$3,367.44
267	361	33	0	\$4,149.34
267	361	34	0	\$4,149.34
267	361	35	0	\$3,367.44
267	361	36	0	\$4,260.40
267	361	37	0	\$4,149.34
267	361	38	0	\$4,260.40
267	361	39	0	\$3,367.44
267	361	40	0	\$4,149.34



**Poway Unified School District  
Improvement Area A of CFD No. 14  
Special Tax Levy For Fiscal Year 2013/2014**

<b>Book</b>	<b>Page</b>	<b>Parcel</b>	<b>Interest</b>	<b>Special Tax</b>
267	361	41	0	\$4,149.34
267	361	42	0	\$3,367.44
267	361	43	0	\$4,149.34
267	361	44	0	\$3,741.50
267	361	45	0	\$3,741.50
267	361	46	0	\$4,149.34
267	361	47	0	\$3,367.44
267	361	48	0	\$3,741.50
267	361	49	0	\$4,149.34
267	361	50	0	\$3,367.44
267	362	1	0	\$4,149.34
267	362	2	0	\$4,149.34
267	362	3	0	\$0.00
267	362	4	0	\$0.00
267	362	5	0	\$0.00
267	362	6	0	\$0.00
267	362	7	0	\$0.00
267	362	8	0	\$0.00
267	362	9	0	\$0.00
267	363	1	0	\$0.00
267	363	2	0	\$0.00
267	363	3	0	\$0.00
267	361	51	0	\$0.00
267	361	52	0	\$0.00
267	361	53	0	\$0.00
267	363	4	0	\$0.00
267	363	5	0	\$0.00
267	363	6	0	\$0.00
267	363	7	0	\$0.00
267	363	8	0	\$0.00
267	362	10	0	\$0.00
267	362	11	0	\$0.00
267	362	12	0	\$0.00
267	362	13	0	\$0.00
267	362	14	0	\$0.00
267	362	15	0	\$0.00
267	362	16	0	\$0.00
267	362	17	0	\$0.00
267	362	18	0	\$0.00
267	362	19	0	\$0.00
267	362	20	0	\$0.00
267	362	21	0	\$0.00
267	362	22	0	\$0.00
267	362	23	0	\$0.00

**Poway Unified School District  
Improvement Area A of CFD No. 14  
Special Tax Levy For Fiscal Year 2013/2014**

<b>Book</b>	<b>Page</b>	<b>Parcel</b>	<b>Interest</b>	<b>Special Tax</b>
267	362	24	0	\$0.00
267	362	25	0	\$0.00
267	362	26	0	\$0.00
267	362	27	0	\$0.00
267	362	28	0	\$0.00
267	362	29	0	\$0.00
267	362	30	0	\$0.00
267	364	1	0	\$0.00
267	364	8	0	\$0.00
267	364	9	0	\$0.00
267	364	16	0	\$0.00
267	364	17	0	\$0.00
267	364	18	0	\$0.00
267	364	19	0	\$0.00
267	364	20	0	\$0.00
267	362	31	0	\$4,149.34
267	362	32	0	\$3,167.54
267	362	33	0	\$4,149.34
267	362	34	0	\$4,149.34
267	362	35	0	\$3,367.44
267	362	36	0	\$4,149.34
267	362	37	0	\$3,167.54
267	362	38	0	\$4,149.34
267	362	39	0	\$4,149.34
267	362	40	0	\$4,149.34
267	362	41	0	\$3,167.54
267	362	42	0	\$4,149.34
267	362	43	0	\$3,367.44
267	362	44	0	\$4,149.34
267	362	45	0	\$4,149.34
267	362	46	0	\$3,167.54
267	362	47	0	\$3,367.44
267	362	48	0	\$4,260.40
267	362	49	0	\$4,260.40
267	362	50	0	\$4,260.40
267	362	51	0	\$4,260.40
267	362	52	0	\$4,260.40
267	362	53	0	\$4,260.40
267	362	54	0	\$4,260.40
267	362	55	0	\$4,260.40
267	362	56	0	\$4,260.40
267	361	54	0	\$4,260.40
267	361	55	0	\$4,260.40
267	361	56	0	\$4,260.40

**Poway Unified School District  
Improvement Area A of CFD No. 14  
Special Tax Levy For Fiscal Year 2013/2014**

<b>Book</b>	<b>Page</b>	<b>Parcel</b>	<b>Interest</b>	<b>Special Tax</b>
267	361	57	0	\$4,260.40
267	361	58	0	\$4,260.40
267	361	59	0	\$4,260.40
267	360	74	0	\$0.00
267	362	64	0	\$0.00
267	364	23	0	\$0.00
267	364	24	0	\$0.00
267	360	83	0	\$0.00
267	360	84	0	\$0.00
267	363	21	0	\$0.00
267	365	1	0	\$0.00
267	365	2	0	\$0.00
267	364	26	0	\$0.00
267	362	65	0	\$0.00
267	360	75	0	\$0.00
267	360	76	0	\$0.00
267	361	60	0	\$0.00
267	362	57	0	\$0.00
267	362	58	0	\$0.00
267	362	59	0	\$0.00
267	362	60	0	\$0.00
267	364	21	0	\$0.00
267	364	22	0	\$0.00
267	360	77	0	\$0.00
267	361	61	0	\$0.00
267	360	78	0	\$0.00
267	360	79	0	\$0.00
267	360	80	0	\$0.00
267	360	81	0	\$0.00
267	360	82	0	\$0.00
267	361	62	0	\$0.00
267	361	63	0	\$0.00
267	361	64	0	\$0.00
267	361	65	0	\$0.00
267	361	66	0	\$0.00
267	362	61	0	\$0.00
267	362	62	0	\$0.00
267	362	63	0	\$0.00
267	370	1	1	\$2,101.34
267	370	1	2	\$2,101.34
267	370	1	3	\$2,101.34
267	370	1	4	\$2,709.96
267	370	1	5	\$2,709.96
267	370	1	6	\$2,709.96

**Poway Unified School District  
Improvement Area A of CFD No. 14  
Special Tax Levy For Fiscal Year 2013/2014**

<b>Book</b>	<b>Page</b>	<b>Parcel</b>	<b>Interest</b>	<b>Special Tax</b>
267	370	1	7	\$2,709.96
267	370	1	8	\$2,101.34
267	370	1	9	\$2,101.34
267	370	1	10	\$2,101.34
267	370	1	11	\$2,101.34
267	370	1	12	\$2,101.34
267	370	1	13	\$2,101.34
267	370	1	14	\$2,709.96
267	370	1	15	\$2,709.96
267	370	1	16	\$2,709.96
267	370	1	17	\$2,709.96
267	370	1	18	\$2,101.34
267	370	1	19	\$2,101.34
267	370	1	20	\$2,101.34
267	370	1	21	\$2,101.34
267	370	1	22	\$2,709.96
267	370	1	23	\$2,709.96
267	370	1	24	\$2,709.96
267	370	1	25	\$2,709.96
267	370	1	26	\$2,101.34
267	370	1	27	\$2,101.34
267	370	1	28	\$2,709.96
267	370	1	29	\$2,709.96
267	370	1	30	\$2,709.96
267	370	1	31	\$2,709.96
267	370	1	32	\$2,101.34
267	370	1	33	\$2,101.34
267	370	1	34	\$2,709.96
267	370	1	35	\$2,709.96
267	370	1	36	\$2,709.96
267	370	1	37	\$2,709.96
267	370	1	38	\$2,101.34
267	370	1	39	\$2,101.34
267	370	1	40	\$2,101.34
267	370	1	41	\$2,101.34
267	370	1	42	\$2,101.34
267	370	1	43	\$2,709.96
267	370	1	44	\$2,709.96
267	370	1	45	\$2,709.96
267	370	1	46	\$2,709.96
267	370	1	47	\$2,101.34
267	370	1	48	\$2,101.34
267	370	1	49	\$2,101.34
267	370	1	50	\$2,709.96

**Poway Unified School District  
Improvement Area A of CFD No. 14  
Special Tax Levy For Fiscal Year 2013/2014**

<b>Book</b>	<b>Page</b>	<b>Parcel</b>	<b>Interest</b>	<b>Special Tax</b>
267	370	1	51	\$2,709.96
267	370	1	52	\$2,709.96
267	370	1	53	\$2,709.96
267	370	1	54	\$2,101.34
267	370	1	55	\$2,101.34
267	370	2	0	\$0.00
267	370	3	0	\$0.00
267	370	4	0	\$0.00
267	370	5	0	\$0.00
267	370	6	0	\$0.00
267	400	1	0	\$3,367.44
267	400	2	0	\$3,741.50
267	400	3	0	\$4,149.34
267	400	4	0	\$3,367.44
267	400	5	0	\$4,149.34
267	400	6	0	\$3,741.50
267	400	7	0	\$3,367.44
267	400	8	0	\$4,149.34
267	400	9	0	\$3,741.50
267	400	10	0	\$4,149.34
267	400	11	0	\$3,367.44
267	400	12	0	\$4,260.40
267	400	13	0	\$4,149.34
267	400	14	0	\$3,741.50
267	400	15	0	\$3,741.50
267	400	16	0	\$4,149.34
267	400	17	0	\$3,367.44
267	400	18	0	\$3,741.50
267	400	19	0	\$3,367.44
267	400	20	0	\$4,149.34
267	400	21	0	\$4,149.34
267	400	22	0	\$3,741.50
267	400	23	0	\$3,741.50
267	400	24	0	\$4,260.40
267	400	25	0	\$3,741.50
267	400	26	0	\$4,149.34
267	400	27	0	\$4,149.34
267	400	28	0	\$3,741.50
267	400	29	0	\$3,367.44
267	400	30	0	\$3,741.50
267	400	31	0	\$3,367.44
267	400	32	0	\$3,741.50
267	400	33	0	\$3,367.44
267	400	34	0	\$4,149.34

**Poway Unified School District  
Improvement Area A of CFD No. 14  
Special Tax Levy For Fiscal Year 2013/2014**

<b>Book</b>	<b>Page</b>	<b>Parcel</b>	<b>Interest</b>	<b>Special Tax</b>
267	400	35	0	\$3,367.44
267	400	36	0	\$3,741.50
267	400	37	0	\$4,149.34
267	400	38	0	\$4,149.34
267	400	39	0	\$3,741.50
267	400	40	0	\$4,260.40
267	400	41	0	\$3,741.50
267	400	42	0	\$4,149.34
267	400	43	0	\$3,367.44
267	400	44	0	\$3,741.50
267	400	45	0	\$4,149.34
267	400	46	0	\$4,149.34
267	400	47	0	\$3,367.44
267	400	48	0	\$3,367.44
267	400	49	0	\$3,741.50
267	400	50	0	\$3,741.50
267	400	51	0	\$3,741.50
267	400	52	0	\$4,149.34
267	400	53	0	\$3,367.44
267	400	54	0	\$4,149.34
267	401	1	0	\$2,945.40
267	401	2	0	\$3,034.26
267	401	3	0	\$2,945.40
267	401	4	0	\$2,945.40
267	401	5	0	\$3,034.26
267	401	6	0	\$2,945.40
267	401	7	0	\$2,945.40
267	401	8	0	\$3,034.26
267	401	9	0	\$2,945.40
267	401	10	0	\$2,945.40
267	401	11	0	\$2,945.40
267	401	12	0	\$3,034.26
267	401	13	0	\$2,945.40
267	401	14	0	\$2,945.40
267	401	15	0	\$3,034.26
267	401	16	0	\$2,945.40
267	401	17	0	\$2,945.40
267	401	18	0	\$3,034.26
267	401	19	0	\$2,945.40
267	401	20	0	\$3,034.26
267	401	21	0	\$2,945.40
267	401	22	0	\$2,945.40
267	401	23	0	\$2,945.40
267	401	24	0	\$3,034.26

**Poway Unified School District  
Improvement Area A of CFD No. 14  
Special Tax Levy For Fiscal Year 2013/2014**

<b>Book</b>	<b>Page</b>	<b>Parcel</b>	<b>Interest</b>	<b>Special Tax</b>
267	401	25	0	\$2,945.40
267	401	26	0	\$3,034.26
267	401	27	0	\$2,945.40
267	401	28	0	\$3,034.26
267	401	29	0	\$2,945.40
267	401	30	0	\$4,260.40
267	401	31	0	\$4,260.40
267	401	32	0	\$4,260.40
267	401	33	0	\$4,260.40
267	401	34	0	\$4,260.40
267	401	35	0	\$4,260.40
267	401	36	0	\$4,260.40
267	401	37	0	\$4,260.40
267	401	38	0	\$4,260.40
267	401	39	0	\$4,260.40
267	401	40	0	\$4,260.40
267	401	41	0	\$4,260.40
267	401	42	0	\$4,260.40
267	401	43	0	\$4,260.40
267	401	44	0	\$4,260.40
267	401	45	0	\$4,260.40
267	401	46	0	\$4,260.40
267	401	47	0	\$4,260.40
267	401	48	0	\$4,260.40
267	401	49	0	\$0.00
267	401	50	0	\$4,260.40
267	401	51	0	\$3,056.48
267	401	52	0	\$4,260.40
267	401	53	0	\$4,260.40
267	401	54	0	\$4,260.40
267	401	55	0	\$4,260.40
267	401	56	0	\$4,260.40
267	401	57	0	\$4,260.40
267	401	58	0	\$4,260.40
267	401	59	0	\$4,260.40
267	401	60	0	\$4,260.40
267	401	61	0	\$4,260.40
267	401	62	0	\$4,260.40
267	401	63	0	\$4,260.40
267	401	64	0	\$4,260.40
267	402	1	0	\$4,260.40
267	402	2	0	\$4,260.40
267	402	3	0	\$4,260.40
267	402	4	0	\$4,260.40

**Poway Unified School District  
Improvement Area A of CFD No. 14  
Special Tax Levy For Fiscal Year 2013/2014**

<b>Book</b>	<b>Page</b>	<b>Parcel</b>	<b>Interest</b>	<b>Special Tax</b>
267	402	5	0	\$0.00
267	402	6	0	\$0.00
267	402	7	0	\$0.00
267	402	8	0	\$0.00
267	402	9	0	\$0.00
267	402	10	0	\$0.00
267	402	11	0	\$0.00
267	402	12	0	\$0.00
267	402	13	0	\$0.00
267	402	14	0	\$0.00
267	402	15	0	\$0.00
267	402	16	0	\$0.00
267	402	17	0	\$0.00
267	402	18	0	\$4,149.34
267	402	19	0	\$3,167.54
267	402	20	0	\$4,149.34
267	402	21	0	\$0.00
267	402	22	0	\$0.00
267	402	23	0	\$0.00
267	402	24	0	\$0.00
267	402	25	0	\$0.00
267	403	6	1	\$2,709.96
267	403	6	2	\$2,709.96
267	403	6	3	\$2,709.96
267	403	6	4	\$2,709.96
267	403	6	5	\$2,101.34
267	403	6	6	\$2,101.34
267	403	6	7	\$2,101.34
267	403	6	8	\$2,101.34
267	403	6	9	\$2,101.34
267	403	6	10	\$2,101.34
267	403	7	1	\$2,101.34
267	403	7	2	\$2,101.34
267	403	7	3	\$2,101.34
267	403	7	4	\$2,709.96
267	403	7	5	\$2,709.96
267	403	7	6	\$2,709.96
267	403	7	7	\$2,709.96
267	403	7	8	\$2,101.34
267	403	7	9	\$2,101.34
267	403	7	10	\$2,101.34
267	403	11	1	\$2,709.96
267	403	11	2	\$2,709.96
267	403	11	3	\$2,709.96



**Poway Unified School District  
Improvement Area A of CFD No. 14  
Special Tax Levy For Fiscal Year 2013/2014**

<b>Book</b>	<b>Page</b>	<b>Parcel</b>	<b>Interest</b>	<b>Special Tax</b>
267	403	11	4	\$2,709.96
267	403	11	5	\$2,101.34
267	403	11	6	\$2,101.34
267	403	11	7	\$2,101.34
267	403	11	8	\$2,101.34
267	403	11	9	\$2,101.34
267	403	11	10	\$2,101.34
267	403	12	1	\$2,709.96
267	403	12	2	\$2,709.96
267	403	12	3	\$2,709.96
267	403	12	4	\$2,709.96
267	403	10	1	\$2,101.34
267	403	10	2	\$2,101.34
267	403	10	3	\$2,101.34
267	403	10	4	\$2,709.96
267	403	10	5	\$2,709.96
267	403	10	6	\$2,709.96
267	403	10	7	\$2,709.96
267	403	10	8	\$2,101.34
267	403	10	9	\$2,101.34
267	403	10	10	\$2,101.34
267	403	9	1	\$2,101.34
267	403	9	2	\$2,709.96
267	403	9	3	\$2,709.96
267	403	9	4	\$2,709.96
267	403	9	5	\$2,709.96
267	403	9	6	\$2,101.34
267	403	8	1	\$2,101.34
267	403	8	2	\$2,101.34
267	403	8	3	\$2,101.34
267	403	8	4	\$2,709.96
267	403	8	5	\$2,709.96
267	403	8	6	\$2,709.96
267	403	8	7	\$2,709.96
267	403	8	8	\$2,101.34
267	403	8	9	\$2,101.34
267	403	8	10	\$2,101.34
267	403	5	1	\$2,101.34
267	403	5	2	\$2,101.34
267	403	5	3	\$2,101.34
267	403	5	4	\$2,709.96
267	403	5	5	\$2,709.96
267	403	5	6	\$2,709.96
267	403	5	7	\$2,709.96

**Poway Unified School District  
Improvement Area A of CFD No. 14  
Special Tax Levy For Fiscal Year 2013/2014**

<b>Book</b>	<b>Page</b>	<b>Parcel</b>	<b>Interest</b>	<b>Special Tax</b>
267	403	5	8	\$2,101.34
267	403	5	9	\$2,101.34
267	403	5	10	\$2,101.34
267	400	55	0	\$0.00
267	400	56	0	\$0.00
267	400	57	0	\$0.00
267	401	65	0	\$0.00
267	401	66	0	\$0.00
267	401	67	0	\$0.00
267	401	68	0	\$0.00
267	401	69	0	\$0.00
267	401	70	0	\$0.00
267	401	72	0	\$0.00
267	401	73	0	\$0.00
267	402	26	0	\$0.00
267	402	27	0	\$0.00
267	403	2	0	\$0.00
267	403	3	0	\$0.00
267	403	4	0	\$0.00
267	401	71	0	\$0.00
267	401	74	0	\$0.00
267	402	28	0	\$0.00
267	402	30	0	\$0.00
267	402	29	0	\$0.00
267	350	63	0	\$3,741.50
267	350	64	0	\$3,167.54
267	350	65	0	\$3,056.48
267	350	66	0	\$3,167.54
267	350	67	0	\$3,741.50
267	350	68	0	\$3,167.54
267	350	69	0	\$3,056.48
267	350	70	0	\$3,741.50
267	350	71	0	\$3,741.50
267	350	72	0	\$3,167.54
267	350	73	0	\$3,167.54
267	350	74	0	\$3,056.48
267	350	75	0	\$3,367.44
267	350	76	0	\$3,167.54
267	350	77	0	\$3,741.50
267	350	78	0	\$3,167.54
267	350	79	0	\$3,741.50
267	350	80	0	\$3,056.48
267	350	81	0	\$3,167.54
267	350	82	0	\$3,741.50

**Poway Unified School District  
Improvement Area A of CFD No. 14  
Special Tax Levy For Fiscal Year 2013/2014**

<b>Book</b>	<b>Page</b>	<b>Parcel</b>	<b>Interest</b>	<b>Special Tax</b>
267	363	23	0	\$0.00
267	363	24	0	\$0.00
267	363	25	0	\$0.00
267	363	26	0	\$0.00
267	363	27	0	\$0.00
267	363	28	0	\$0.00
267	363	29	0	\$0.00
267	363	30	0	\$0.00
267	363	31	0	\$0.00
267	363	32	0	\$0.00
267	364	27	0	\$0.00
267	364	28	0	\$0.00
267	364	29	0	\$0.00
267	364	30	0	\$0.00
267	364	31	0	\$0.00
267	364	32	0	\$0.00
267	364	33	0	\$0.00
267	364	34	0	\$0.00
267	364	35	0	\$0.00
267	364	36	0	\$0.00
267	364	37	0	\$0.00
267	364	38	0	\$0.00
267	363	33	0	\$0.00
267	363	34	0	\$0.00
267	364	39	0	\$0.00
267	363	35	0	\$0.00
267	250	31	0	\$0.00
267	281	41	0	\$0.00
267	341	24	0	\$0.00
267	231	57	0	\$0.00
267	313	8	0	\$0.00
267	313	2	0	\$0.00
267	313	3	0	\$0.00
267	150	30	0	\$0.00
267	150	13	0	\$0.00
267	150	32	0	\$0.00
267	270	10	0	\$0.00
0	0	0	0	\$0.00
0	0	0	0	\$0.00
0	0	0	0	\$0.00
0	0	0	0	\$0.00
0	0	0	0	\$0.00
0	0	0	0	\$0.00
0	0	0	0	\$0.00

**Poway Unified School District  
Improvement Area A of CFD No. 14  
Special Tax Levy For Fiscal Year 2013/2014**

<b>Book</b>	<b>Page</b>	<b>Parcel</b>	<b>Interest</b>	<b>Special Tax</b>
0	0	0	0	\$0.00
0	0	0	0	\$0.00
0	0	0	0	\$0.00
0	0	0	0	\$0.00
0	0	0	0	\$0.00
0	0	0	0	\$0.00
0	0	0	0	\$0.00
0	0	0	0	\$0.00
0	0	0	0	\$0.00

<b>Major Conclusions</b>	
Total Number of Parcels	1,269
Number of Parcels Taxed	1,047
Total Special Tax Levy for Fiscal Year 2013/2014	\$3,211,584.38